

Cycling is one of the most important forms of transport for modern times. The national and global shift towards everything environmental and healthy are epitomised in cycling.

Local authorities, architects, designers, commercial and industrial organisations are all changing and adapting to embrace the challenge of cycling – and each group has its own needs and ideas.

Falco has been involved in providing cycle parking solutions for many years and we have developed an unparalleled range of stands, racks, stores and shelters to suit every requirement. In this section we present the current range of distinctive racks and stands for cycle parking.

From the basic Sheffield stand through to the innovative double height FalcoLevel or even sophisticated bespoke parking systems, In addition, our equally large range of shelters and canopies (in the following section) are designed to complement the cycle parking systems shown here.

Across the range there is a great variation in form and function.

The diversity of design and style enables specifiers to find products with a design element, which will not only complement a scheme, but positively add value to any streetscape. Cycling is a positive activity in many ways - health, cost, environmental and much more - the benefits are clear! So let us help to solve your infrastructure needs with high quality cycle parking systems which are both functional and attractive and let's promote cycling within your community.

CYCLE PARKING



FALCOSUPP CYCLE LEANING
SUPPORT RAIL | 109



SHEFFIELD STANDS | 110-113



TRIANGLE STAND | 114



FALCOFAIR STAND | 115



FALCOTOASTER
RACK | 116/117



TRIANGLE-10, TRIANGLE-20 AND TRIANGLE-30 | 118/119

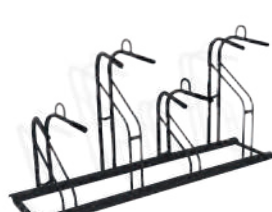

IDEAL 2.0 RACK | 120/121

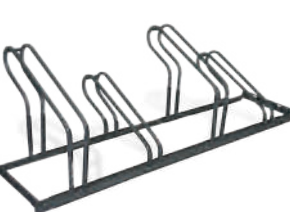

A-11/A-11B RACK | 122/123

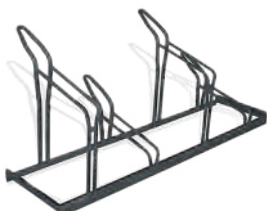

FALCOSOUND
RACK | 124/125

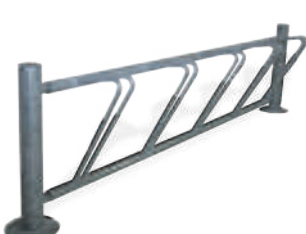

FALCO-DK RACK | 126/127

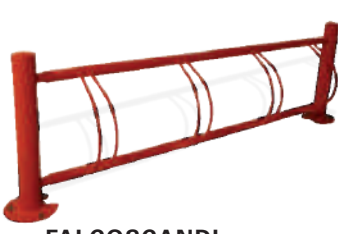

FALCOSCANDI
RACK | 126/127



FALCOHANGER | 128



FALCOTUMBLER | 129



FALCOLEVEL PREMIUM+
TWO-TIER RACK | 130-133



FALCOVERT | 134



FALCOMAT
STAND | 135



HANGING
RAIL RACK | 135



F-7 AND F-8
CLAMP | 136/137



F-1
WALL CLAMP | 138



FALCOCRATE
RACK | 139



FALCOFIX 2.0
CYCLE STATION | 140



FALCOBOOST
CYCLE PUMP | 141



FALCOSAFE
LOCKER | 142/143



FALCOCASE
LOCKER | 144/145



FALCOSUPP CYCLE LEANING RAIL

The FalcoSupp is a convenient and easy to use leaning barrier designed to support cyclists at traffic lights and rail crossings. The simple, yet effective design features two supports, one allowing the cyclist to grasp with their hands and the other with their feet.

The FalcoSupp is an added value product designed to facilitate a cyclists journey and to stimulate the flow of traffic by encouraging the cyclist to remain seated rather than dismounting at key junctions.

The FalcoSupp reduces the chances of a fall by encouraging cyclists to remain seated during temporary stops, this is even more important when cycling with heavier e-bikes.

FALCOSUPP	
PART CODE	DESCRIPTION
02.020.000*	below ground fix, 3,000mm long, 1,261mm above ground height, 300mm below ground depth
02.020.060*	surface fix, 3,000mm long, 1,275mm height

*All steelwork can be powder coated in any of the 192 standard RAL colours upon request, simply add 'PC' to the start of any part code(s) listed to the left.



The FalcoSupp is an ergonomic bicycle support with an integral foot rest and friendly hand grip. Ideal for cyclists to use while waiting for the green light. By using the FalcoSupp support , cyclists can get on their bike faster.

The support has a length of 3 meters and can be used by several cyclists at one time. Following research throughout European cycling countries, FalcoSupp has been designed to deliver excellent ergonomics and a very user-friendly cycling experience.

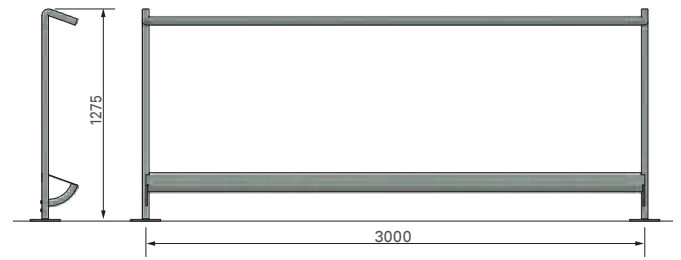

FalcoSupp, part code 02.020.060



SHEFFIELD STANDS

Sheffield stands are the most fundamental of cycle parking products. Two cycles can be secured, one on either side with a chain or cable lock. They are available with base plates for surface mounting or with longer legs for below ground fixing into concrete.

Additionally there are options with or without a cross strut, as well as in different diameter tubes.

Normally placed at 800mm intervals, Sheffield stands are a sound, friendly and affordable bicycle parking solution.

All Falco stands are hot dip galvanised to BS EN ISO 1461 and additionally can be powder coated.

The stands are available with base plates for surface fix or with an extended tube for below ground fix. Available in Ø41.5mm, Ø47.5mm and Ø60.0mm.



Falco also offers the Sheffield stands in stainless steel with or without cross-struts. Available in Ø48.3mm.



STAINLESS STEEL SHEFFIELD STANDS

SHEFFIELD STANDS				
PART CODE	Ø DIAM.	WIDTH	HEIGHT	FIX
02.008.000	41.5mm	900 mm	1,100mm	below ground fix
02.008.015	41.5mm	900 mm	800mm	base plates
02.520.000	47.5mm	900 mm	1,250mm	below ground fix
02.520.010	47.5mm	900 mm	900mm	base plates
02.521.000	47.5mm	1,200 mm	1,250mm	below ground fix
02.522.010	47.5mm	1,200 mm	900mm	base plates
02.522.000	47.5mm	1,500 mm	1,250mm	below ground fix
02.521.010	47.5mm	1,500 mm	900mm	base plates
02.561.000	60.0mm	1,200 mm	1,250mm	below ground fix
02.561.010	60.0mm	1,200 mm	900mm	base plates
02.562.000	60.0mm	1,500 mm	1,250mm	below ground fix
02.562.010	60.0mm	1,500 mm	900mm	base plates

SHEFFIELD STANDS (STAINLESS STEEL)				
PART CODE	DIAMETER Ø	WIDTH	HEIGHT	
05.240.000	48.3mm	900 mm	1,250mm	below ground fix
05.240.010	48.3mm	900 mm	900mm	surface fix
05.241.000	48.3mm	1,200 mm	1,250mm	below ground fix
05.241.010	48.3mm	1,200 mm	900mm	surface fix

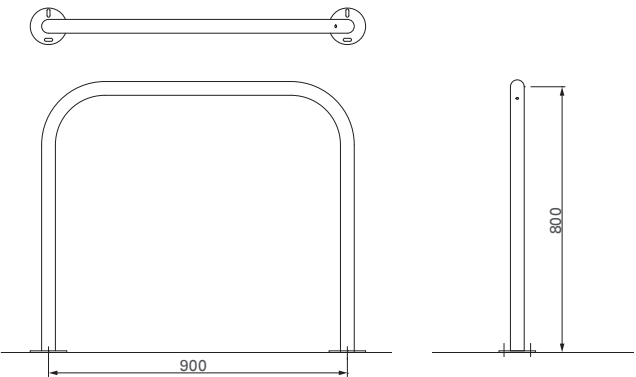

Sheffield stand (Ø41.5mm), part code 02.008.015

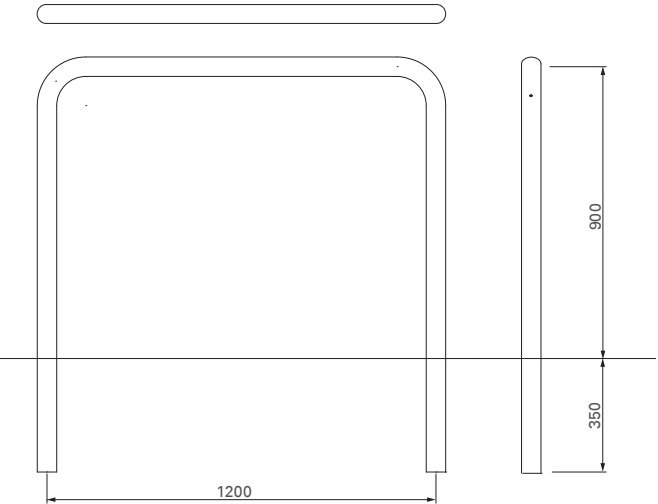

Sheffield stand (Ø60.0mm), part code 02.561.000



SHEFFIELD STAND Ø41,5 mm | 02.008.015



SHEFFIELD STANDS WITH CROSS STRUT (Ø41.5mm)

SHEFFIELD STANDS
(WITH CROSS STRUT)

Identical to the standard Sheffield stand, the cross strut is added between the two legs for added security and rigidity.

Sheffield stands are the most fundamental of cycle parking products. Two cycles can be secured, one on either side with a chain or cable lock. They are available with base plates for surface mounting or with longer legs for below ground fixing into concrete.

All Falco stands are hot dip galvanised to BS EN ISO 1461 and additionally can be powder coated in a choice of 192 standard RAL colours.

The stands are available with base plates for surface fix or with an extended tube for below ground fix. Available in Ø41.5mm, Ø47.5mm and Ø60.0mm.



Falco also offers the Sheffield stands in stainless steel with or without cross-struts. Available in Ø48.3mm.



STAINLESS STEEL SHEFFIELD STANDS

SHEFFIELD STANDS WITH CROSS STRUT				
PART CODE	Ø DIAM.	WIDTH	HEIGHT	FIX
02.010.000	41.5mm	900 mm	1,100mm	below ground fix
02.010.010	41.5mm	900 mm	900mm	base plates
02.520.000	47.5mm	900 mm	1,250mm	below ground fix
02.520.010	47.5mm	900 mm	900mm	base plates
02.521.000	47.5mm	1,200 mm	1,250mm	below ground fix
02.521.010	47.5mm	1,200 mm	900mm	base plates
02.522.000	47.5mm	1,500 mm	1,250mm	below ground fix
02.522.010	47.5mm	1,500 mm	900mm	base plates
02.551.000	60.0mm	1,200 mm	1,250mm	below ground fix
02.551.009	60.0mm	1,200 mm	900mm	base plates
02.552.000	60.0mm	1,500 mm	1,250mm	below ground fix
02.552.009	60.0mm	1,500 mm	900mm	base plates

SHEFFIELD STANDS WITH CROSS STRUT (STAINLESS STEEL)				
PART CODE	DIAMETER Ø	WIDTH	HEIGHT	
05.250.000	48.3mm	900 mm	1,250mm	below ground fix
05.250.010	48.3mm	900 mm	900mm	surface fix
05.251.000	48.3mm	1,200 mm	1,250mm	below ground fix
05.251.010	48.3mm	1,200 mm	900mm	surface fix

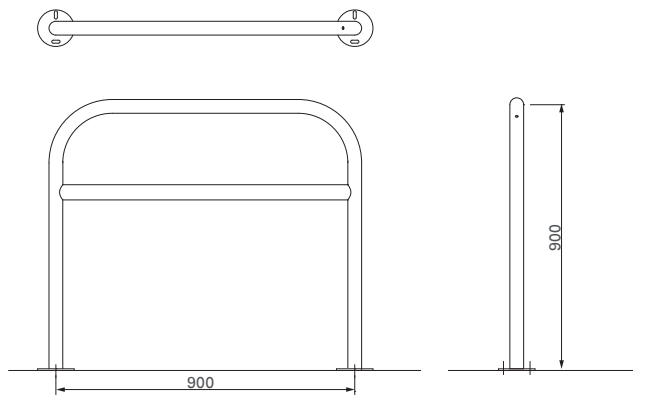

Sheffield stand (Ø41.5mm), part code 02.010.010

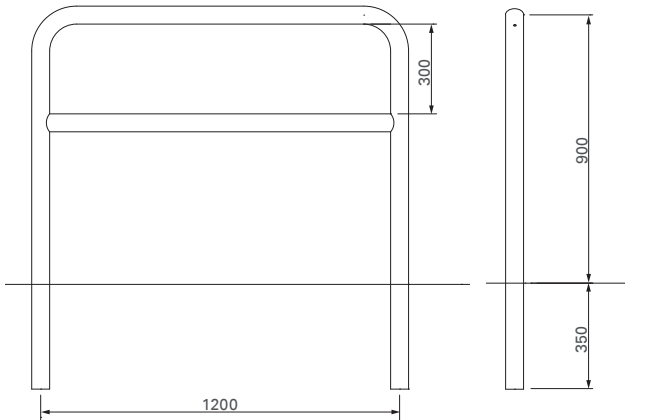

Sheffield stand (Ø60.0mm), part code 02.551.000



SHEFFIELD WITH CROSS STRUT | 02.010.000



TRIANGLE CYCLE STANDS AND TRIANGLE CYCLE CANOPY <page 174/175>

TRIANGLE CYCLE STAND

A great design led alternative to the Sheffield stand, the fin shaped cycle stand is part of our ‘Triangle’ range of co-ordinated street furniture <page 14/15>.The design is very user friendly in that it gives all sizes of bicycles something to lean against. The main tube of the stand is Ø60.3mm x 2.9mm thick steel and can be supplied with anchor parts to grout in or base plates for surface fix.



TRIANGLE CYCLE STAND | 01.568.026

TRIANGLE CYCLE STAND	
PART CODE	DESCRIPTION
01.568.000	below ground fix
01.568.026	on baseplates (130x150x8mm)

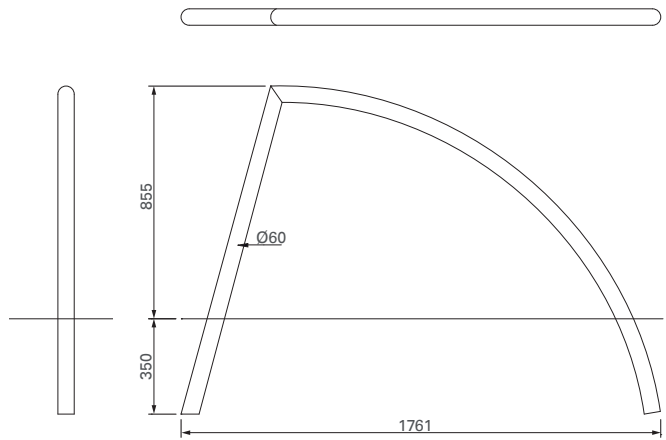

Triangle cycle stand, part code 01.568.000



FALCOFAIR CYCLE STAND

A further variation to the cycle stand/leaning bracket is the curvy FalcoFair with its Greek ‘pi’ shape. The stand is manufactured from 3 symmetrical robust steel sections welded in a curved profile. The stand is 1,024mm wide and 900mm high above ground level. It is a solid design thanks to the use of 40mm profile tube.

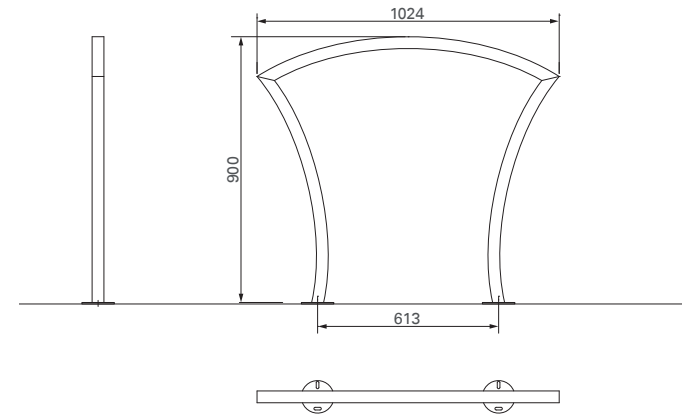

FalcoFair, part code 02.015.010

FALCOFAIR CYCLE STAND	
PART CODE	DESCRIPTION
02.015.000	total height 1,100mm, below ground fix
PC02.015.000	total height 1,100mm, powder coated in RAL ____
02.015.010	height 900mm on base plates (Ø110mm)
PC02.015.010	height 900mm on base plates (Ø110mm), powder coated in RAL ____



FALCOFAIR POWDER COATED | PC02.015.010



FALCOTOASTER RACKS IN A FALCOQUARTER CYCLE COMPOUND <page 154/155>

FALCOTOASTER CYCLE RACK

As its name suggests, the FalcoToaster, mounts rows of Sheffield stands on a purpose built frame creating a ‘toast rack’ effect. This is a great option for temporary installations or where digging up the floor is not appropriate. The range accommodates between 4 and 10 cycles with different spacing options.

The securing supports are mounted 600mm, 750mm or 800mm apart. The FalcoToaster is particularly useful for public use, as it can be used from 2 sides, is sturdy and appealing in its simplicity. The base supporting tubes have holes for mounting the FalcoToaster on a level base. The top hole is larger so that the bolt fixing is concealed within the rail.

All Falco steelwork is hot dip galvanized to BS EN ISO 1461 and can additionally be powder coated in any of the 192 RAL colours.



FALCOTOASTER | 01.245.004

FALCOTOASTER			
PART CODE	NUMBER OF SUPPORTS	CTC	LENGTH
01.245.002	2	600mm	1,200mm
01.245.003	3	600mm	1,800mm
01.245.004	4	600mm	2,400mm
01.245.005	5	600mm	3,000mm
01.245.102	2	750mm	1,500mm
01.245.103	3	750mm	2,250mm
01.245.104	4	750mm	3,000mm
01.245.105	5	800mm	4,000mm
99.000.011	aluminium coupling to join FalcoToasters		
	(2 required)		



BESPOKE FALCOTOASTER RACK, WITH LASER CUT SIDE PANELS



FALCOTOASTER | 2x 01.245.005

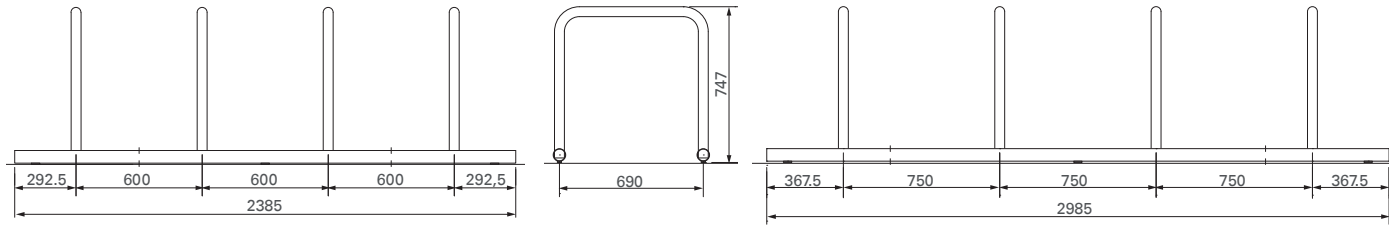
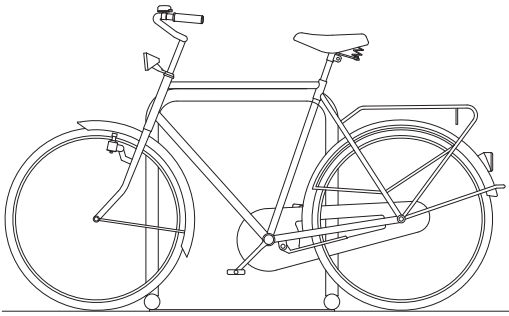

FalcoToaster, part code 01.245.004

part code 01.245.104



Photo: ipv Delft

TRIANGLE-10 CYCLE STANDS

TRIANGLE CYCLE STAND SERIES

There are three versions of the Triangle cycle stand with wheel brackets: Triangle-10, Triangle-20 and Triangle-30.

Each stand has wheel brackets integrated into the design with three general options;

- a) a single wheel low bracket on the left only.
- b) a single wheel high bracket on the right only.
- c) a single wheel low bracket on the left and a high bracket on the right.

TRIANGLE-10	
PART CODE	DESCRIPTION
01.550.000	1 low cycle space left, with anchor part
01.550.025	1 low cycle space left, with base plate
01.551.000	double-sided 2 low and 2 high, with anchor part
01.551.025	double-sided 2 low and 2 high, with base plate
01.553.000	1 high cycle space right, with anchor part
01.553.025	1 high cycle space right, with base plate
01.554.000	1 high and 1 low cycle space, with anchor part
01.554.025	1 high and 1 low cycle space, with baseplate

TRIANGLE-10 CYCLE STAND

Has recognisable triangle design wheel clamps with a single central support and individual locking eyes. Also available in a double-sided design with 4 spaces.



TRIANGLE-10 | PC01.554.000

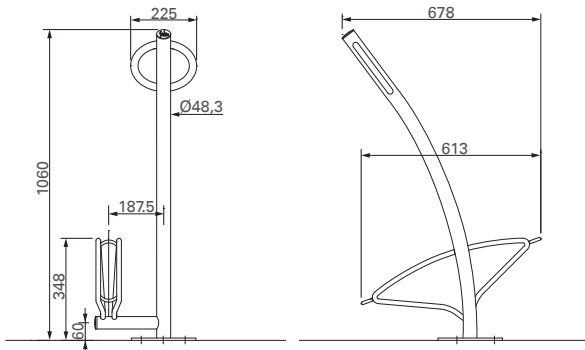

Triangle-10, part code 01.550.025

The Triangle range of cycle stands offer a real design-led cycle parking option to encourage the use of cycling.



TRIANGLE-20 | PC01.559.000

TRIANGLE-20 CYCLE STAND

Has recognisable triangle design wheel clamps with a dual central support creating a large single locking eye. Also available in a double sided design with 4 spaces (upon request).

TRIANGLE-20	
PART CODE	DESCRIPTION
01.555.000	1 low cycle space left, with anchor part
01.555.025	1 low cycle space left, with baseplate
01.558.000	1 high cycle space right, with anchor part
01.558.025	1 high cycle space right, with baseplate
01.559.000	1 high and 1 low cycle space, with anchor part
01.559.025	1 high and 1 low cycle space, with baseplate

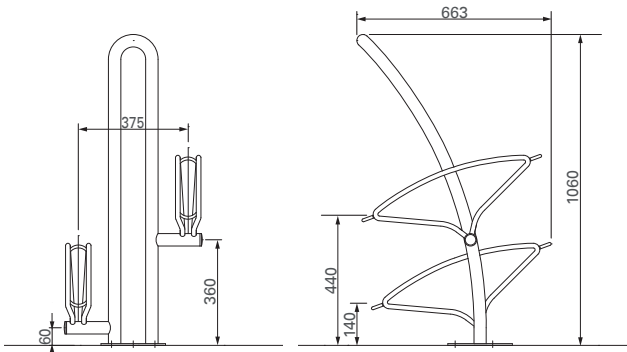

Triangle-20, part code 01.559.025

All of the Triangle cycle stand products are hot-dip galvanised and can be polyester powder-coated in any of the 192 standard RAL colours.



TRIANGLE-30 | 01.564.026

TRIANGLE-30 CYCLE STAND

Has recognisable triangle design wheel clamps with a 'fin' Sheffield stand support. The model is also available without wheel brackets <page 116>.

TRIANGLE-30	
PART CODE	DESCRIPTION
01.560.000	1 low cycle space left, with anchor parts
01.560.026	1 low cycle space left, with baseplates
01.563.000	1 high cycle space right, with anchor parts
01.563.026	1 high cycle space right, with baseplates
01.564.000	1 high and 1 low cycle space, with anchor parts
01.564.026	1 high and 1 low cycle space, with baseplates

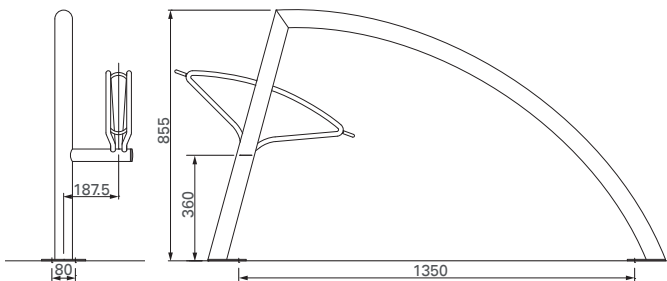

Triangle-30, part code 01.563.026



IDEAL 2.0 SINGLE-SIDED CYCLE RACK

IDEAL 2.0 CYCLE RACK

The Ideal 2.0 cycle rack features an enhanced aesthetic design, accomodates wider tyres and is even easier to maintain than the original Ideal rack!

As with all Falco products, the Ideal 2.0 is exceptionally robust, user-friendly and functional.

The Ideal 2.0 is the successor to the standard Ideal rack accommodating wider tyres and with an enhanced aesthetic design. The Ideal 2.0 has a centre to centre distance of 400mm and can accommodate wider tyres due to a wider recess of each wheel support.

A locking eye provides additional security to the cyclist and a protective sleeve prevents damage to the front fork.

The enhanced cycle rack design ensures minimal accumulation of debris which is easier to clean and results in lower maintenance costs.

The cycle rack can be equipped with an addon support to act as an additional locking point. This optional support is manufactured from steel and integrated into the rack.

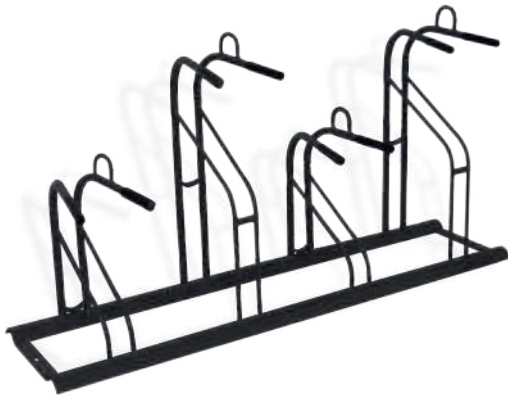

IDEAL 2.0 SINGLE SIDED | 00.804.040

IDEAL 2.0 SINGLE SIDED	
PART CODE	DESCRIPTION
00.804.040	4 place, c.t.c. 400mm, length 1,600mm
00.854.040	4 place, c.t.c. 400mm, length 1,600mm, with additional locking bars
00.805.040	5 place, c.t.c. 400mm, length 2,000mm
00.855.040	5 place, c.t.c. 400mm, length 2,000mm with additional locking bars
00.806.040	6 place, c.t.c. 400mm, length 2,400mm
00.856.040	6 place, c.t.c. 400mm, length 2,400mm, with additional locking bars

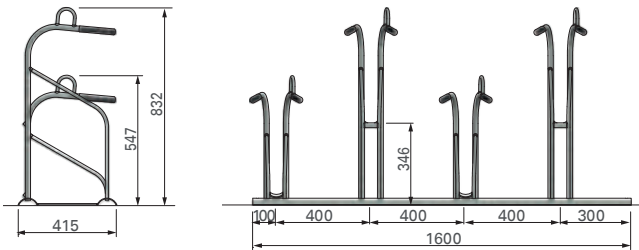

Ideal 2.0, part code 00.804.040

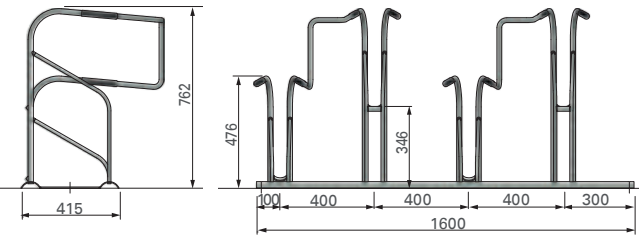

Ideal 2.0, part code 00.854.040



IDEAL 2.0 DOUBLE SIDED,
with additional locking bars | 00.878.020

IDEAL 2.0 DOUBLE SIDED	
PART CODE	DESCRIPTION
00.824.020	4 place (2x2), c.t.c. 200mm, length 800mm
00.874.020	4 place (2x2), c.t.c. 200mm, length 800mm, with additional locking bars
00.826.020	6 place (2x3), c.t.c. 200mm, length 1,200mm
00.876.020	6 place (2x3), c.t.c. 200mm, length 1,200mm, with additional locking bars
00.828.020	8 place (2x4), c.t.c. 200mm, length 1,600mm
00.878.020	8 place (2x4), c.t.c. 200mm, length 1,600mm, with additional locking bars

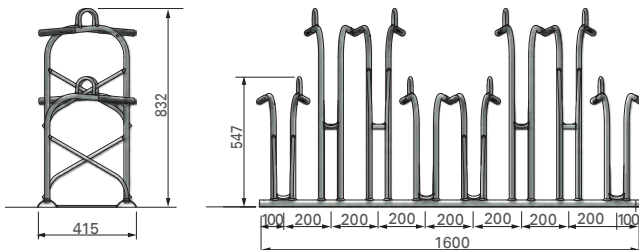

Ideal 2.0, part code 00.828.020

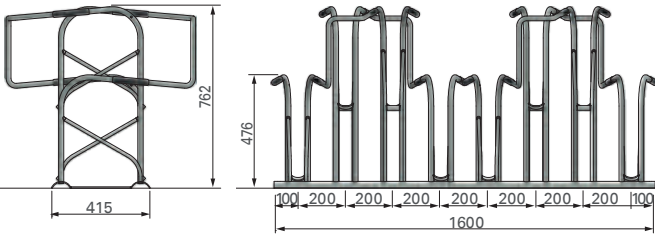

Ideal 2.0, part code 00.878.020



A-11MB CYCLE RACK | 00.006.037

A-11 CYCLE RACK

The standard A-11 rack for racing bikes is available in two variants, with spacing’s either 300mm or 375mm centres. Available as a single or double sided version.

A-11MB MOUNTAIN CYCLE RACK

The ‘MB’ version has slightly wider tube spacing’s to accommodate the larger tyres on mountain bikes. Additionally the spacing of the cycle places is increased to 400mm, to reduce the likelihood of handle bars clashing. Available as single or double sided versions.

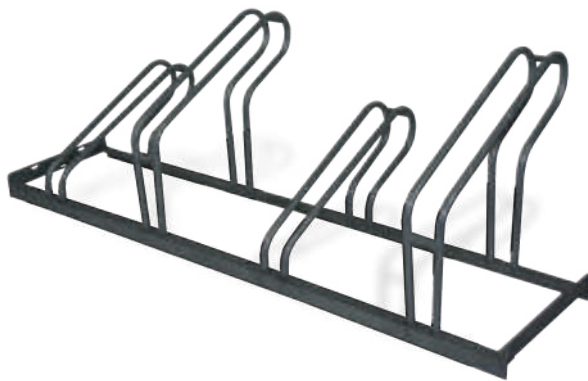
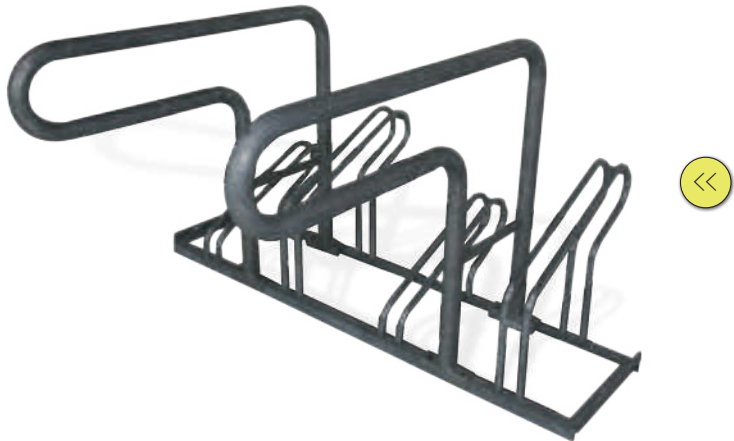

A-11 CYCLE RACK | 00.004.037

A-11(MB) SINGLE SIDED	
PART CODE	DESCRIPTION
00.004.037	4 place, c.t.c. 375mm, length 1,500mm
00.006.037	6 place, c.t.c. 375mm, length 2,250mm
00.008.037	8 place, c.t.c. 375mm, length 3,000mm
00.004.240	4 place, c.t.c. 400mm, length 1,600mm
00.005.240	5 place, c.t.c. 400mm, length 2,000mm
00.006.240	6 place, c.t.c. 400mm, length 2,400mm

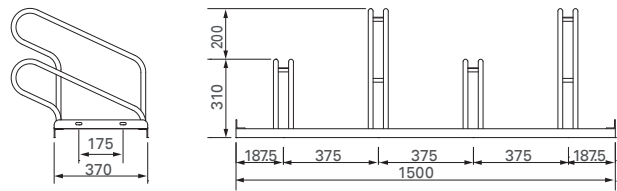

A-11, part code 00.004.037

Single sided racks can be equipped with add-on supports or fastening supports. The protruding section means that the cyclist can remain behind the bicycle. In order to ensure quality, the racks are drilled before hot-dip galvanised; the supports or posts are only fitted afterwards.

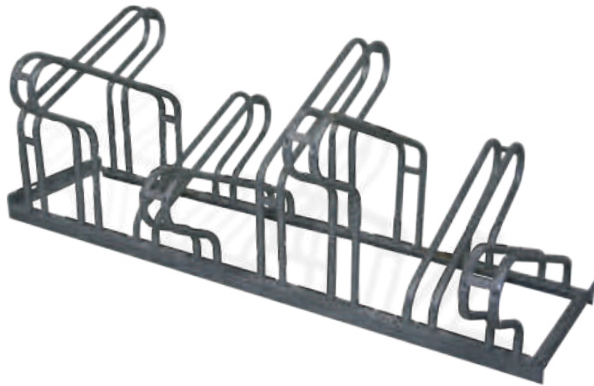

A-11B CYCLE RACK | 00.028.018

A-11B DOUBLE SIDED	
PART CODE	DESCRIPTION
00.028.018	8 place (4 each side), c.t.c. 187.5mm, length 1,500mm
00.032.018	12 place (6 each side), c.t.c. 187.5mm, length 2,250mm
00.028.220	8 place (4 each side), c.t.c. 200mm, length 1,600mm
00.032.220	12 place (6 each side), c.t.c. 200mm, length 2,400mm

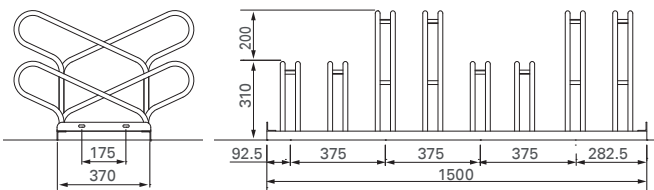

A-11B, part code 00.028.018



FALCOSOUND CYCLE RACK

FALCOSOUND

The FalcoSound is a space saving and user friendly cycle parking system ideal for securing the front wheel of a bicycle. The great flexibility of this cycle rack enables it to meet all applications; whether you’re planning to locate it indoors or outdoors; on the street, in a compound or a basement, the FalcoSound is flexible enough to meet any requirement.

The cycle rack alternates wheel positioning using a high and low system which allows secure accommodation for a maximum number of cycles. Available as a single or double sided version.

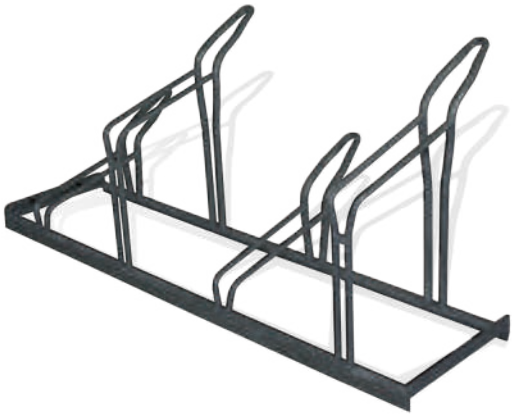

FALCOSOUND CYCLE RACK | 00.104.037

FALCOSOUND SINGLE SIDED	
PART CODE	DESCRIPTION
00.104.037	4 place, c.t.c. 375mm, length 1,500mm
00.106.037	6 place, c.t.c. 375mm, length 2,250mm
00.108.037	8 place, c.t.c. 375mm, length 3,000mm
00.104.040	4 place, c.t.c. 400mm, length 1,600mm
00.106.040	6 place, c.t.c. 400mm, length 2,400mm
00.108.040	8 place, c.t.c. 400mm, length 3,300mm

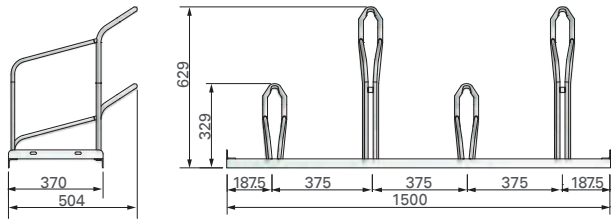

FalcoSound, part code 00.104.037

The cycle rack is optionally available with a locking eye for increased security, allowing the user to secure their own chain or padlock to the frame of the bike.

The protruding section means that the cyclist can remain behind the bicycle. The cycle rack is manufactured from hot-dip galvanised steel and can be optionally powder coated in any of the 192 RAL colours.



FALCOSOUND CYCLE RACK | 00.128.018

FALCOSOUND DOUBLE SIDED	
PART CODE	DESCRIPTION
00.128.018	8 place (4 each side), c.t.c. 187.5mm, length 1,500mm
00.132.018	12 place (6 each side), c.t.c. 187.5mm, length 2,250mm
00.128.020	8 place (4 each side), c.t.c. 200mm, length 1,600mm
00.132.020	12 place (6 each side), c.t.c. 200mm, length 2,400mm

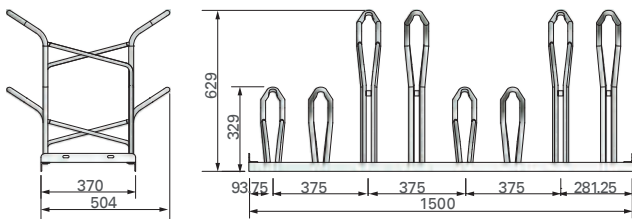

FalcoSound, part code 00.128.018



FALCOSCANDI DOUBLE-SIDED CYCLE RACK

FALCO-DK CYCLE RACK

The Falco-DK cycle rack is one of our most popular cycle rack designs. The design of the wheel support means this cycle rack is suitable for virtually any bicycle, with a spacing of 500mm apart, the Falco-DK provides outstanding stability by clamping the front fork. The cycle rack is made up of two supports, one on either side of the cycle rack (with intermediate supports on longer racks) with individual wheel clamps. The use of intermediate support posts allows the cycle rack to be constructed in a continuous run as far as required.



FALCO-DK CYCLE RACK

FALCOSCANDI CYCLE RACK

The FalcoScandi is similar in design to the Falco-DK cycle rack, but offers a circular wheel support design as opposed to the Falco-DK's triangular support.



FALCOSCANDI CYCLE RACK

FALCO-DK/FALCOSCANDI UPRIGHTS	
PART CODE	DESCRIPTION
01.310.010	start/end support, length 1,050mm
01.310.011	start/end support with base plate, length 660mm
01.311.010	intermediary support, length 1,050mm
01.311.011	intermediary support with base plate, length 660mm
01.312.000L	wall support, left
01.312.000R	wall support, right
01.312.100	wall support, intermediary

FALCO-DK RACK, SINGLE SIDED	
PART CODE	DESCRIPTION
01.314.050	4 place, c.t.c. 500mm, length 1,830mm, 90°
01.314.862L	4 place, c.t.c. 625mm, length 2,330mm, 45° left
01.314.862R	4 place, c.t.c. 625mm, length 2,330mm, 45° right
01.315.050	5 place, c.t.c. 500mm, length 2,330mm, 90°
01.315.862L	5 place, c.t.c. 625mm, length 2,955mm, 45° left
01.315.862R	5 place, c.t.c. 625mm, length 2,955mm, 45° right

FALCO-DK RACK, DOUBLE SIDED	
00.328.050	2x4 place, c.t.c. 500mm, length 1,830mm, 90°
00.330.050	2x5 place, c.t.c. 500mm, length 2,330mm, 90°
00.332.050	2x6 place, c.t.c. 500mm, length 2,830mm, 90°



FALCO-DK SINGLE RACK, 45°

FALCOSCANDI RACK, SINGLE SIDED	
PART CODE	DESCRIPTION
01.464.050	4 place, c.t.c. 500mm, length 1,830mm, 90°
01.465.050	5 place, c.t.c. 500mm, length 2,330mm, 90°
01.466.050	6 place, c.t.c. 500mm, length 2,830mm, 90°

FALCOSCANDI RACK, DOUBLE SIDED	
00.478.050	2x4 place, c.t.c. 500mm, length 1,830mm, 90°
00.480.050	2x5 place, c.t.c. 500mm, length 2,330mm, 90°
00.482.050	2x6 place, c.t.c. 500mm, length 2,830mm, 90°

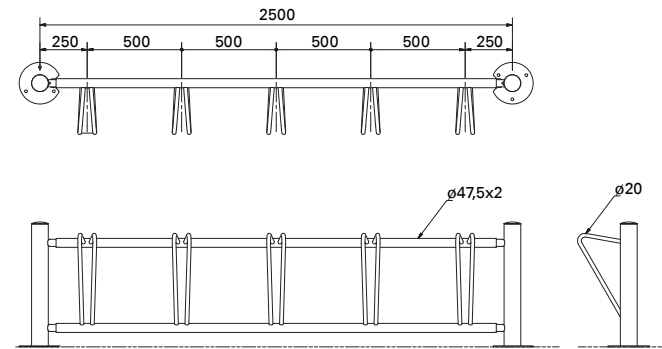

Falco-DK,
2x part code 01.310.011 + 1x part code 01.315.050

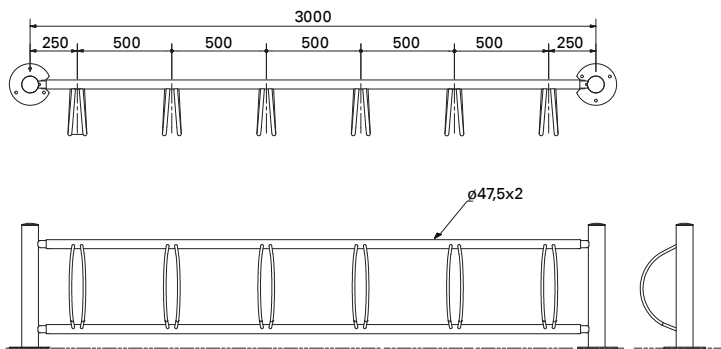

FalcoScandi,
2x part code 01.310.011 + 1x part code 01.466.050



FALCOHANGER CYCLE RACK

A simple cycle parking system ideal for locations where security is not an issue such as private offices and garages. The rack is designed to accommodate 98% of bikes. A protective plastic cover protects the handle bars from scratches.

FALCOHANGER	
PART CODE	DESCRIPTION
00.510.000*	starter/end upright, height 2,220mm, below ground fix
00.510.212*	starter/end upright, height 1,380mm on base plates
00.511.000*	intermediate upright, height 2,220mm, below ground fix
00.511.212*	intermediate upright, height 1,380mm on base plates
00.516.037*	traverse for 6 bikes c.t.c. 375mm, length 2,190mm
00.518.037*	traverse for 8 bikes c.t.c. 375mm, length 2,940mm
00.532.018*	traverse for 2x6 bikes c.t.c. 187.5mm, length 2,310mm
00.536.018*	traverse for 2x8 bikes c.t.c. 187.5mm, length 3,060mm

*All steelwork can be powder coated in any of the 192 standard RAL colours, simply add ‘PC’ to the start of any part code(s) listed.

The rack is available in single and double sided units using a high-low system so that space is used to maximum effect. The single sided version is available in 6 or 8 cycle parking spaces with the double sided version available in 12 or 16 spaces.

FALCOHANGER RACK | 00.518.037

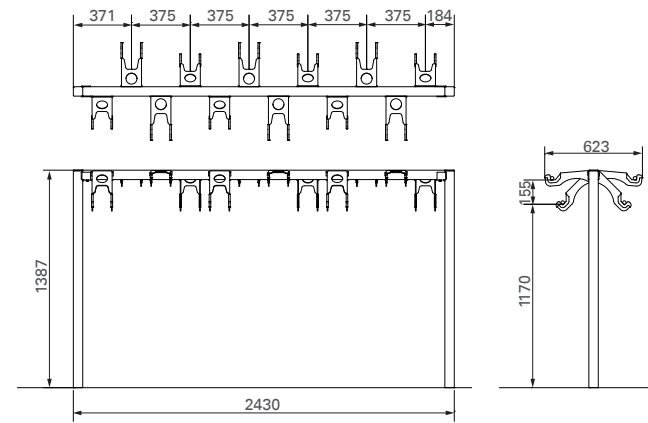

FalcoHanger, part code 00.510.212 (2x) + 00.532.018 (1x)



FALCOTUMBLER

FALCOTUMBLER

The FalcoTumbler is a cycle parking system designed to securely park all types of cycles regardless of wheel or tyre, size or diameter. The cycle rack makes use of a self-adjustable wheel support system, allowing cyclists to adjust the rack to their own cycle requirement.

The FalcoTumbler is a European patented cycle parking system, patent number: 2012755.



With a traditional cycle rack a cycle wheel is secured in three separate places, one either side of the wheel and one in front. However with the FalcoTumbler, there is only one fixed point and two adjustable points, allowing the clamp to always adjust itself to the wheel or tyre diameter.

The FalcoTumbler is available in a single sided variant or a double sided variant.

FALCOTUMBLER	
PART CODE	DESCRIPTION
01.414.037*	single sided, 4 place, c.t.c. 375mm, length 1,500mm
01.414.040*	single sided, 4 place, c.t.c. 400mm, length 1,600mm
01.418.020*	double sided, 2x4 place, c.t.c. 200mm, length 1,600mm

*All steelwork can be powder coated in any of the 192 standard RAL colours upon request, simply add ‘PC’ to the start of any part code(s) listed above.

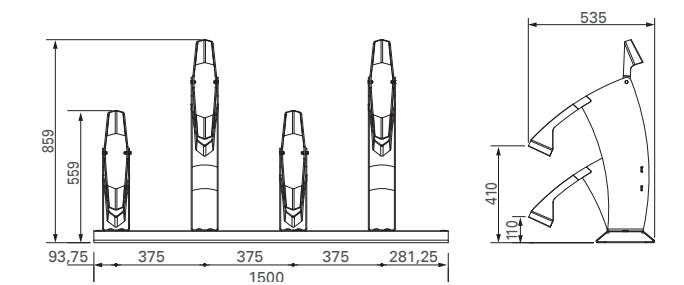

FalcoTumbler, part code 01.414.037



FALCOLEVEL PREMIUM+ IN A FALCOGAMMA 2HI CYCLE COMPOUND <page 172/173>

FALCOLEVEL PREMIUM+

Go Dutch with the FalcoLevel Premium+ a gear change in usability and design. The FalcoLevel Premium+ is an innovative and user friendly cycle parking system which accommodates twice the number of bicycles compared to any other traditional cycle rack or stand.

Manufactured from robust steel and aluminium, it creates a significant reduction in noise pollution, is smoother to operate and is just as easy to park a bike on the upper rack as the lower rack

It can be a real puzzle to park all bikes in the available space. A two tier system is the perfect solution in this situation.

The FalcoLevel Premium+ is available in a centre to centre distance of 375mm or 400mm. To enhance the number of cycle spaces available we advise choosing a 375mm centre to centre distance.



Features

Some key features of the FalcoLevel Premium+ arise from it's development cycle:

- The FalcoPremium+ has excellent build quality, typical of a Falco product.
- Utilises 'Stabilus' gas struts (world market leader in gas struts as used in the automotive industry).
- Rollers are manufactured from hard wearing nylon with a stainless steel bearing.
- Adjustable feet for uneven surfaces.
- Each space can be provided with a number, symbol or charactor upon request.
- A catch prevents the rack from sliding backwards.



Benefits

Compared to traditional two tier cycle parking systems, the aluminium FalcoLevel Premium+ two tier cycle rack from Falco, has some distinct benefits over its rivals:

- Significant sound reduction from upper tier removing a large amount of noise pollution.
- Smoother action for the storage and retrieval of bikes.
- Just as easy to park a bicycle on the upper rack as the lower rack.
- Better suited for modern bikes with higher and wider handle bars.
- Connect multiple units side by side for as long as required.
- Available as a single or double sided version.
- Suitable for cycle tyres with a thickness of 27-50mm.
- Lighter to use than steel units making upper tier available to more cyclists.
- Ergonomic handgrip, with a thicker, warm to touch material that can be lifted with one or two hands.
- Lower lifting height (of the bike into the gutter).
- The roll in angle of the bike is less steep.
- Integrated floating feet for mounting on uneven surfaces.
- Modular design enables flexible c.t.c. bike spacing measurements.
- Stylish looking modern European design.
- Has multiple locking points for differing cycle designs.
- Robust welded construction for steel framework - hot dip galvanised to BS EN ISO 1461 and available in 192 RAL colours).
- Modular design enables flexible c.t.c. bike spacing measurements.
- Robust welded construction for steel framework - hot dip galvanised to BS EN ISO 1461 and available in 192 RAL colours).



Optional locking points

There are two optional locking systems to secure a bike to the FalcoLevel-Premium+ two-tier cycle rack:

- Locking point to be bolted on: to provide additional security for cycles. Available for the lower and higher spaces. Can only be provided for new racks.

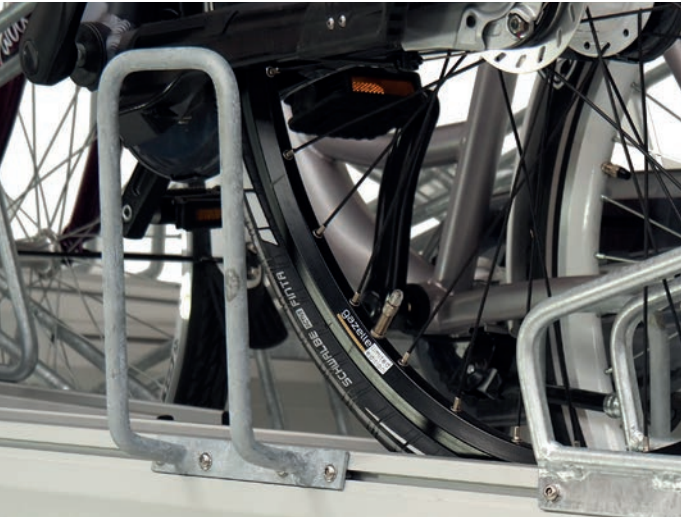

- Lower locking point: to provide additional security for cycles parked on the lower racks with a centre to centre distance of 400mm, a secure locking mount can be supplied. This secure locking mount can be provided for both new racks and existing racks.



Other options

- Upright Cover Plate: An upright end cover plate can be supplied upon request for cycle parking areas unable to expand using standard add-on sections.
- Cycle Space Identification: Each cycle parking space can be allocated with a number or company logo or scheme to identify individual cycle parking spaces.



FALCOLEVEL PREMIUM+	
PART CODE	DESCRIPTION
00.354.040	single sided FalcoLevel Premium+, 4 places in upper - and 4 places in the lower tier, c.t.c. 400mm, length 1,643mm
00.372.020	double sided FalcoLevel Premium+, 12 places in upper - and 12 places in the lower tier, c.t.c. 200mm, length 2,443mm

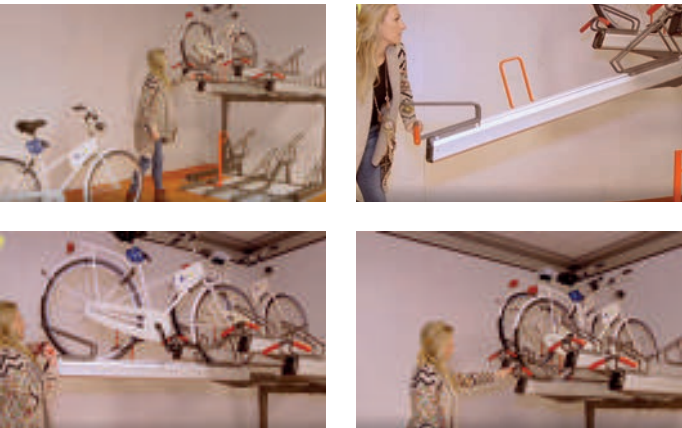

The FalcoLevel Premium+ is suitable for indoor or outdoor use. Falco also manufacture a range of single sided and double sided shelter and canopy structures ideal for sheltering the two-tier system.

FALCOLEVEL PREMIUM+, OPTIONAL	
PART CODE	DESCRIPTION
00.352.000H	loose provision to be bolted on for two point locking of the bike, for the upper level
00.352.000L	loose provision to be bolted on for two point locking of the bike, for the lower level
00.352.040L	lower rack locking point, security for cycles parked on the lower racks
OND00.350.310	FalcoLevel Premium+ upright cover plate

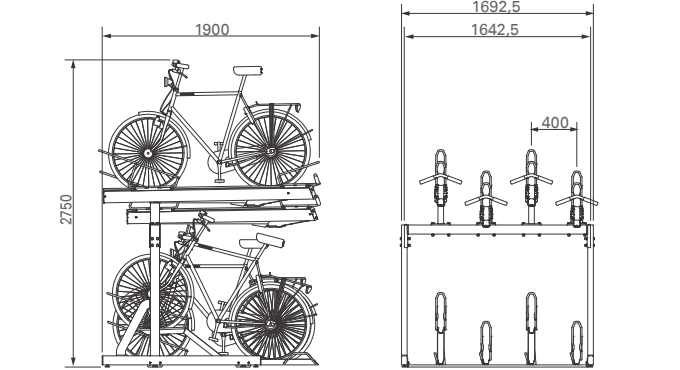

FalcoLevel Premium+, part code 00.354.040



FALCOVERT

FALCOVERT

The FalcoVert is a space saving cycle rack design ideal for highly popular densities such as stations, cycle hubs, shopping centres, high streets and car parks etc.

The FalcoVert is a compact cycle parking system which securely parks bicycles in a semi vertical position with both front and rear wheels located in a custom designed trough.



- Features and Benefits of the FalcoVert cycle rack include:
- Suitable to store all types of bicycles - from racing bikes to mountain bikes and bikes with extra wide tyres
 - Can accommodate any number of cycles
 - Fully locates both wheels in a custom designed tapered steel trough
 - Available in a single or double sided variant

FALCOVERT	
PART CODE	DESCRIPTION
00.564.030	4 place, c.t.c. 305mm, length 1,220mm
00.564.040	4 place, c.t.c. 400mm, length 1,600mm
00.566.030	6 place, c.t.c. 305mm, length 1,830mm
00.566.040	6 place, c.t.c. 400mm, length 2,400mm

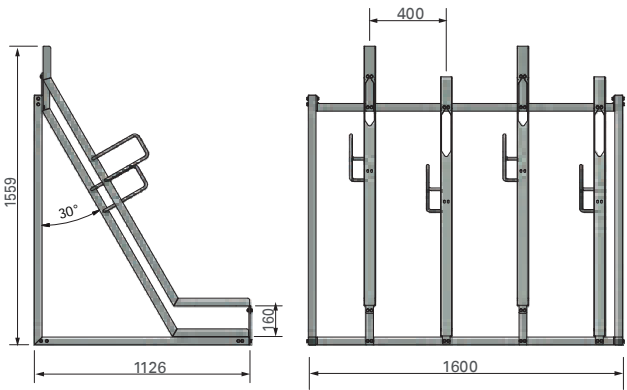

FalcoVert, part code 00.564.040



FALCOMAT WALL STAND

The FalcoMat is a very popular wall mounted cycle parking unit and a great space saving solution. Using an ingenious gas strut assisted mechanism, the FalcoMat makes vertical mounting of cycles very easy. Simply attach the front wheel to the hook, pull the bicycle towards you and the bicycle is automatically raised! Robust, secure and space saving, the FalcoMat is easily mounted onto the wall with just two bolts.

FALCOMAT	
PART CODE	DESCRIPTION
01.900.000	wall stand for one bicycle

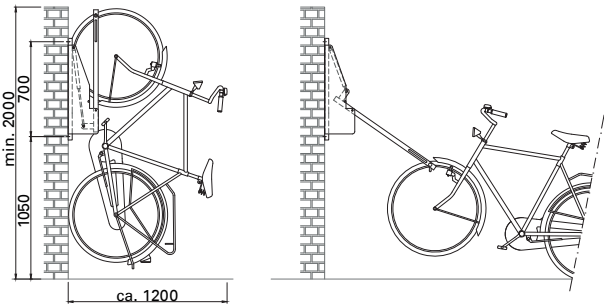

FalcoMat, part code 01.900.000



FALCO HANGING RAIL

The Falco Hanging Rail system consists of 4 stainless steel hooks mounted on a rail. Bicycles can be suspended by their front wheel from the hooks. The rail can be secured to a wall or ceiling by means of 2 supports.

Because the bicycles are suspended, little depth is needed. This makes the hanging rail extremely suitable for smaller spaces such as cellars, sheds and garages.

FALCO HANGING RAIL	
PART CODE	DESCRIPTION
01.094.000	complete set for mounting to a ceiling
01.094.100	complete set for mounting to a wall

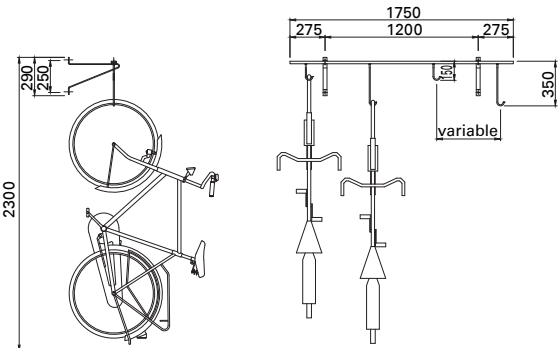

Falco Hanging Rail, part code 01.094.100



F-7 CYCLE CLAMP

F-7 AND F-8 CYCLE CLAMPS

Cycle clamps are general purpose, floor mounted, low cost solutions for areas where vandalism and theft are not an issue. A great economical way to provide cycle parking in mass numbers where standard leaning hoops such as Sheffield stands are not appropriate.

The F-7 clamp is a heavy duty single cycle clamp made of solid Ø20mm steel. Hot-dip galvanised. Equipped with 120mm anchor piece or with concrete block for insertion into ground.

The F-8 is a double sided version of the F-7 cycle clamp. Both models are available with or without a concrete base.



F-7 | 01.160.xxx F-8 | 01.162.xxx

F-7 AND F-8 CLAMP	
PART CODE	DESCRIPTION
01.160.000	F-7 single clamp, with 120mm anchor piece
01.160.171	F-7 single clamp, with 200mm anchor piece
01.160.100	F-7 single clamp, with concrete base
01.162.000	F-8 double clamp, with 150mm anchor piece
01.162.171	F-8 double clamp, with 200mm anchor piece
01.160.100	F-7 single clamp, with concrete base

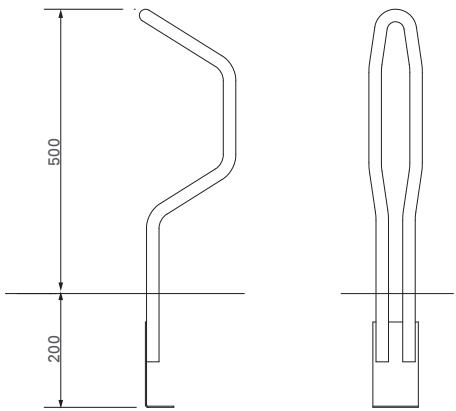

F-7, part code 01.160.171

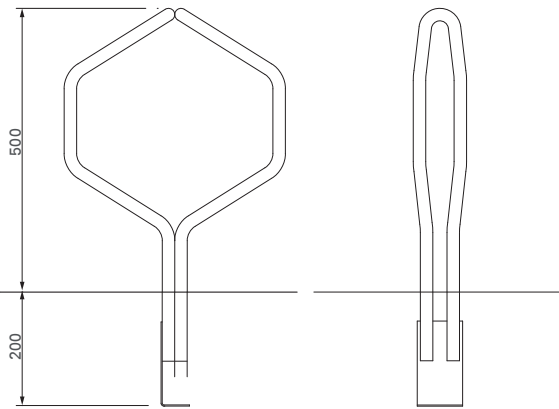

F-8, part code 01.162.171

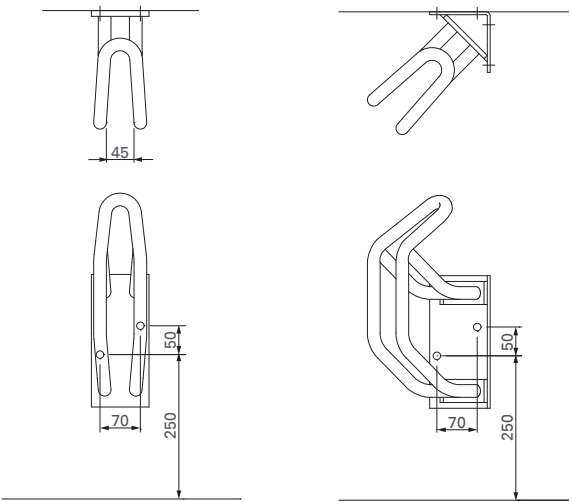

F-7MS, part code 01.141.090 and 01.141.045



F-7MS | 01.141.090

F-7MS/F-7MSB WALL CLAMP

Heavy duty cycle wall clamp made of solid Ø20mm welded steel onto a 230x100mm mounting plate which is 8mm thick and has been hot-dip galvanised.

Equipped with 2 fixing holes of Ø13mm diameter. Available in 90° and 45°. We recommend that the clamps are fitted at a centre to centre distance of 750mm at 90° and 1060mm at 45°. The centre of the clamp should be mounted 350mm above the ground.

The F-7MSB is the variant suitable for accommodating mountain bikes.

F-7MBS WALL CLAMP	
PART CODE	DESCRIPTION
01.141.090	F-7MS wall clamp 90°
01.141.045	F-7MS wall clamp 45°
01.148.090	F-7MBS wall clamp 90°
01.148.045	F-7MBS wall clamp 45°



F-1 90° CLAMP

F-1 WALL CLAMP

A sturdy cycle wall clamp with wheel supports made of solid Ø12mm steel. Hot-dip galvanised to BS EN ISO 1461. Available in 90° and 45°.

We recommend that the clamps are fitted at a centre to centre distance of 650mm at 90° and 920mm at 45°. The centre of the clamp should be mounted 350mm above the ground. Stainless steel mounting bolts can be ordered separately.

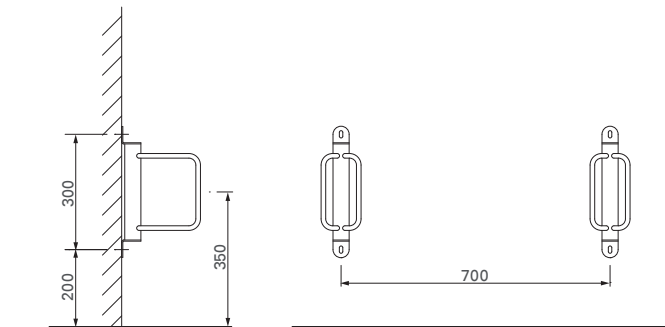

F-1, part code 01.120.090

F-1 WALL CLAMP	
PART CODE	DESCRIPTION
01.120.090	F-1 wall clamp 90°
01.120.045	F-1 wall clamp 45°



F-1 45°



FALCOCRATE

The FalcoCrate is a purpose designed cycle rack to accommodate bicycles with integrated storage baskets. This style of bike requires a wider length to prevent each cycle from clashing side by side and subsequently the FalcoCrate has been purposely designed to provide a secure and userfriendly solution.

The FalcoCrate makes use of a high/low design allowing cycles to be accommodated closer together without any handlebars or baskets clashing. The innovative design prevents bicycles from rolling backwards.

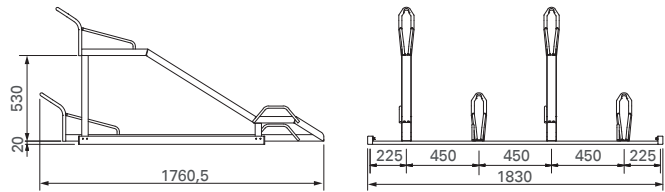

FalcoCrate, part code 01.154.045



The cycle rack has a centre to centre distance of 450mm with a 530mm low/high height different.

FALCOCRATE	
PART CODE	DESCRIPTION
01.153.045	3 place, c.t.c. 450mm, length 1,380mm
01.154.045	4 place, c.t.c. 450mm, length 1,830mm
01.156.045	6 place, c.t.c. 450mm, length 2,730mm



FALCOFIX 2.0

FALCOFIX 2.0 CYCLE STATION

The FalcoFix 2.0 transforms a traditional bicycle pump into a convenient repair and maintenance station for all types of bikes. Ideal for stations, cycle hubs and other dedicated cycle parking facilities, the FalcoFix 2.0 features a number of useful tools to carry out basic cycle maintenance.

The bicycle simply hangs by resting the seat post in between the station support arms, allowing full motion of the wheels and the pedals. A rubber coating to the support arms prevents any scratches to the bike.

From gear and brake adjustment to tyre inflation, the FalcoFix 2.0 features a number of useful tools to carry out basic cycle maintenance. The FalcoFix 2.0 is seperated into two different parts to increase usability.

FALCOFIX 2.0	
PART CODE	DESCRIPTION
01.994.000*	cycle station, 1,407mm tall
96.245.450	concrete securing block for below ground level

*All steelwork can be powder coated in any of the 192 standard RAL colours upon request, simply add 'PC' to the start of any part code(s) listed to the left.

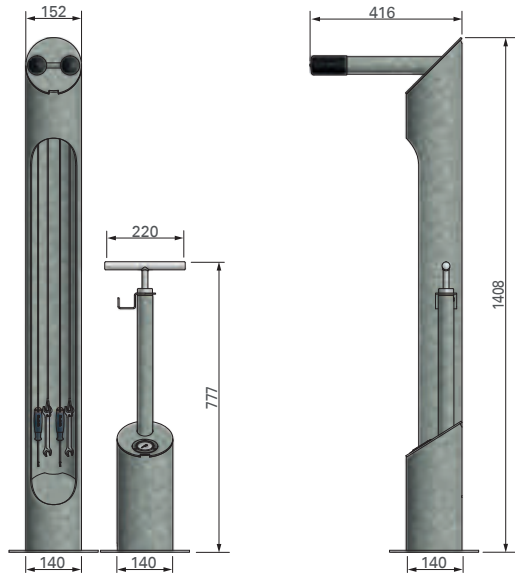

FalcoFix 2.0, part code 01.964.000



FALCOBOOST

FALCOBOOST CYCLE PUMP

The FalcoBoost is a heavy-duty cycle pump design, enabling cyclists to quickly and conveniently inflate their bicycle tyres. With cycling growing in popularity every day, the FalcoBoost lends a helping hand to ensure bicycles are suitable for riding. The FalcoBoost is positioned at a slight angle to allow greater visibility for the cyclist to view the pressure gauge.

The FalcoBoost can incorporate text or brand logos to add to the feel of a cycling campaign or brand identity. The pump features a universal adapter compatible with all types of bicycles with a protective layer making it ideal for public use.

The FalcoBoost features a welded base plate for surface fixing into concrete. Alternatively the FalcoBoost can be supplied with a concrete block for insertion into the ground.

FALCOBOOST	
PART CODE	DESCRIPTION
01.991.000*	cycle pump with pressure gauge, with welded base plates, 692mm high
96.245.450	concrete securing block for below ground level

*All steelwork can be powder coated in any of the 192 standard RAL colours upon request, simply add 'PC' to the start of any part code(s) listed to the left.

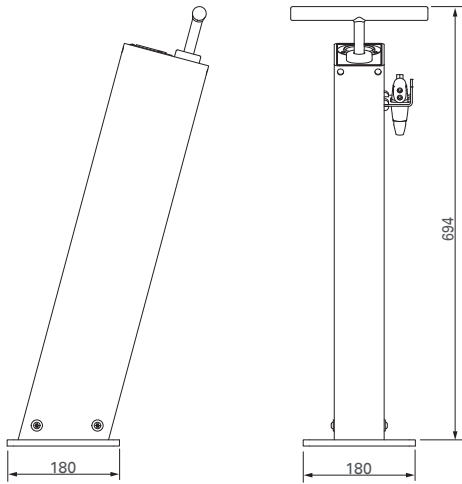

FalcoBoost, part code 01.991.000





FALCOSAFE CYCLE LOCKERS

FALCOSAFE CYCLE LOCKER

The FalcoSafe locker is a robust and secure cycle storage unit and comes in two standard sizes; one for cycles and one for mopeds.

The perforated sides mean that the contents remain visible for security whilst providing ventilation. Side wall perforated panels are contoured for extra strength.

The individual design is completed with a gable roof; to deter roof access.

A huge variety of attractive colour combinations are available for the FalcoSafe locker using any of the 192 RAL colours.

The standard locker is suitable for securing with a user’s padlock but a number of other locking options are available including; coin return, coin retain and Euro-profile lock options.

The bicycle is supported in the locker along a channel up to a cycle clamp. Any number of cycle lockers can be linked together. In addition, the lockers can also be positioned back to back.

FALCOSAFE	
PART CODE	DESCRIPTION
01.801.000	FalcoSafe cycle locker, starter for 1 bicycle, in perforated profiled steel plate, door with facility for padlock
01.801.031	FalcoSafe cycle locker, starter for 1 bicycle, in perforated profiled steel plate, door with dead- lock W453H, incl. europrofile cylinder +3 keys
01.805.000	FalcoSafe cycle locker, add-on for 1 bicycle: in perforated profiled steel plate, door with facility for padlock
01.805.031	FalcoSafe cycle locker, add-on for 1 bicycle: in perforated profiled steel plate, door with dead- lock W453H & cylinder & 3 keys, excl. cylinder
01.821.000	FalcoSafe moped locker, starter for 1 moped, in perforated profiled steel plate, door with facility for padlock
01.825.000	FalcoSafe moped locker, add-on for 1 moped: door with facility for padlock, back wall, one side wall of perforated profiled steel plate

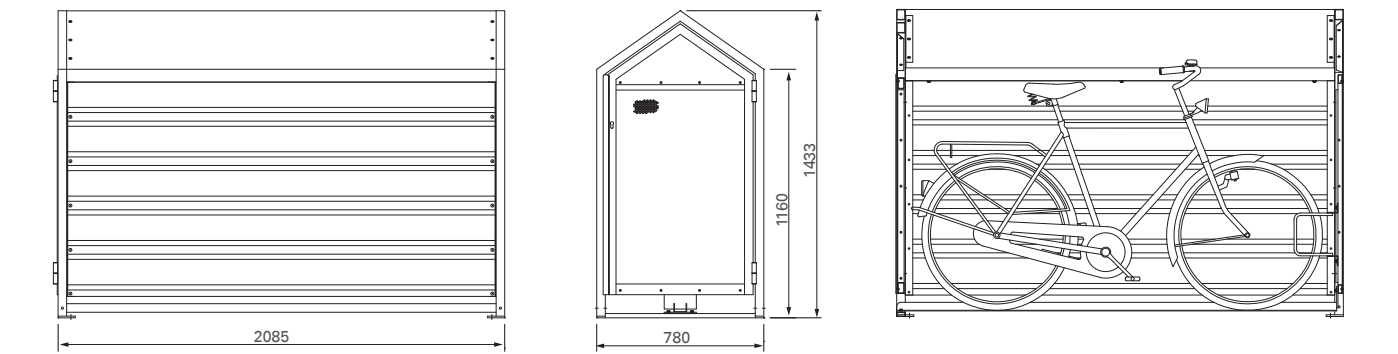

FalcoSafe, part code 01.801.000

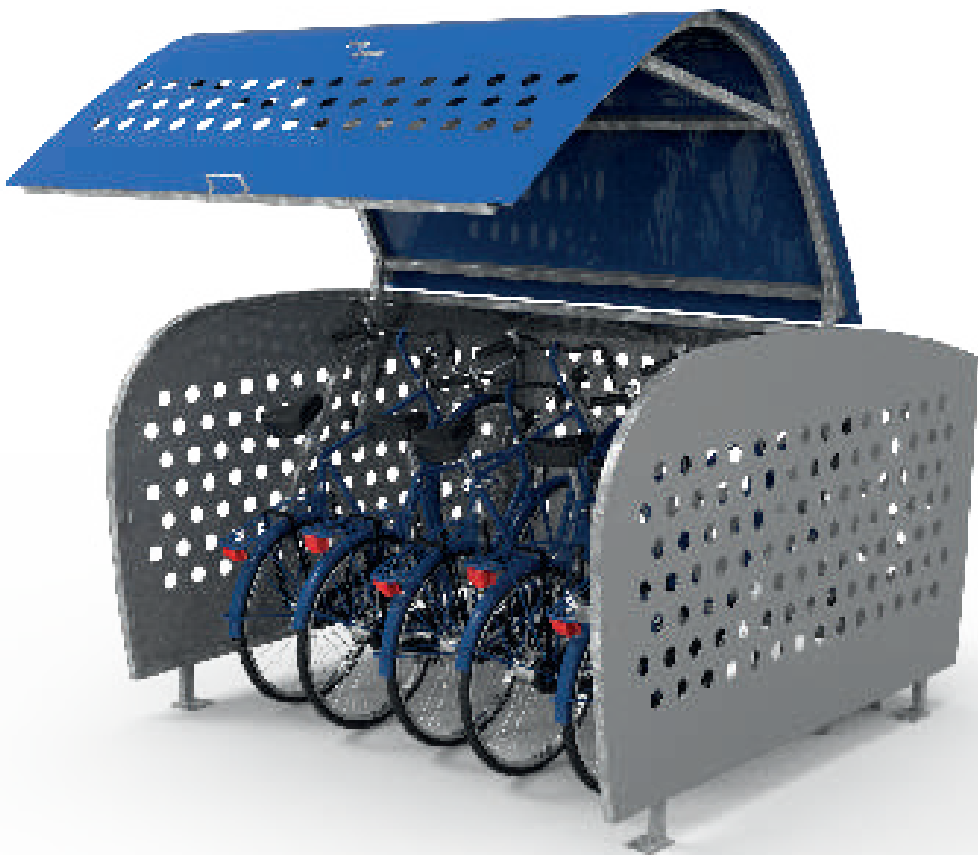

FALCOCASE CYCLE LOCKER

FALCOCASE CYCLE LOCKER

The FalcoCase is the perfect solution for securely housing up to 5 bikes at offices, housing estates or where renting is a requirement

Operating like a giant breadbin, the FalcoCase is cylindrical in design with an upward moving, curved door at the front. The door is equipped with gas struts to facilitate the process of opening.

The door is supplied with a Europrofile cylinder lock for additional security.

The FalcoCase has a smooth curvaceous design with a perforated door and side walls providing visibility and maximum ventilation.



A huge variety of attractive colour combinations are available for the FalcoCase design using any of the 192 standard RAL colours. The door and the side walls can be powder coated in separate colours.

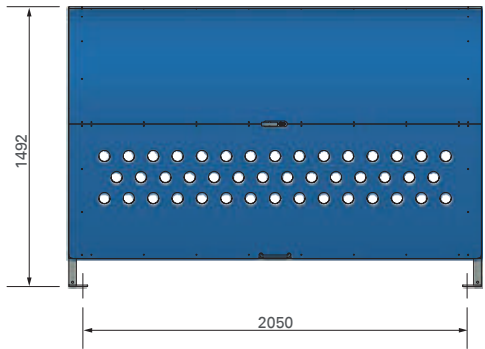
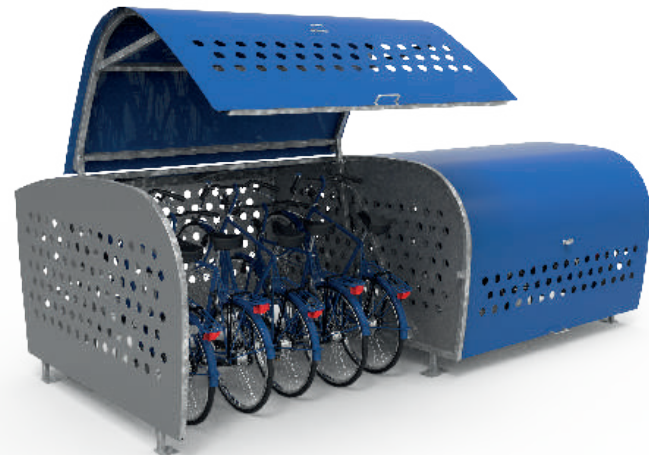

FALCOCASE	
PART CODE	DESCRIPTION
01.910.000	FalcoCase cycle locker, for 5 bicycles, sheeting powdercoated in RAL ____
PC01.910.000	FalcoCase cycle locker, for 5 bicycles, steel construction powdercoated in RAL ____
00.805.037	Ideal 2.0 single-sided bicycle rack, 5 place, c.t.c. 375mm, length 1,875mm
00.105.037	FalcoSound single-sided bicycle rack, 5 place, c.t.c. 375mm, length 1,875mm

The FalcoCase can accommodate up to 5 bikes using the recommended FalcoSound cycle rack see page 120/121 or the Ideal 2.0 cycle rack see page 124/125 (cycle racks sold separately).

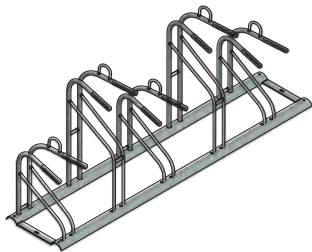

Ideal cycle rack

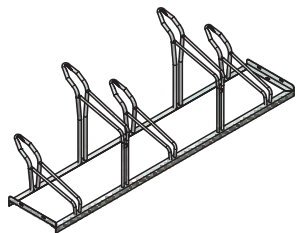

FalcoSound cycle rack

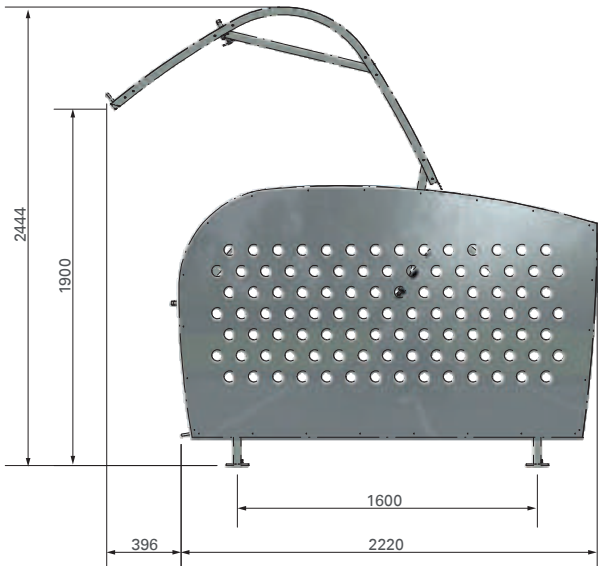

FalcoCase, part code 01.910.000

SHELTERS, CANOPIES, WALKWAYS AND CABINS



Falco's huge range of high quality shelters, canopies and walkway structures provides a comprehensive product portfolio for any project requirement. With over 50 years experience, Falco bring a large amount of expertise into the integration and development of sheltered structures into public areas.

Falco shelters can be used for a huge range of different purposes including cycle shelters, smoking shelters, waiting shelters, teen shelters, bus shelters, outdoor classrooms, storage shelters, walkways, carports and entrance canopies.

Whether utilitarian or design-led, Falco shelters exert style coupled with high functionality, enabling to fit into all schemes and environments. Plus the modular nature of Falco shelters and canopy systems enables designers to create a structure in unlimited sizes and orientations.

For more information about any of the products listed in this section, please visit our website at www.falco.nl.

CYCLE SHELTERS AND CYCLE STORES



CYCLE HUBS | 152/153



FALCOQUARTER CYCLE SHELTER | 154/155



FALCOQUARTER CYCLE COMPOUND | 154/155



FALCOSAIL CYCLE SHELTER | 156/157



FALCOSAIL CYCLE COMPOUND | 156/157



FALCOLITE CYCLE SHELTER | 158/159



FALCOLITE DOUBLE-SIDED CYCLE SHELTER | 160



FALCOLITE CYCLE COMPOUND | 161



FALCOBREEZE CYCLE CANOPY | 162/163

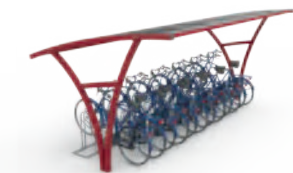

FALCORAIL LOW CYCLE CANOPY | 164/165

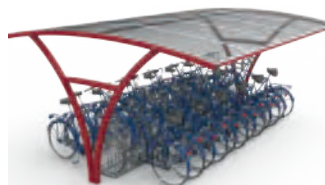

FALCORAIL LOW DOUBLE CYCLE CANOPY | 164/165

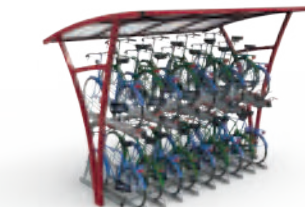

FALCORAIL CYCLE CANOPY | 166/167

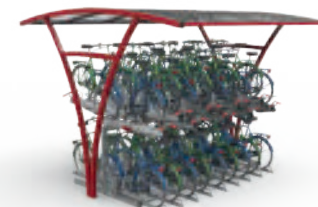

FALCORAIL DOUBLE-SIDED CYCLE CANOPY | 166/167



FALCOGAMMA CYCLE CANOPY | 168-171



FALCOGAMMA DOUBLE-SIDED CYCLE CANOPY | 168-171

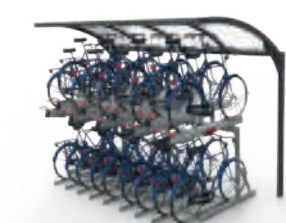

FALCOGAMMA 2HI CYCLE CANOPY | 172/173



FALCOGAMMA 2HI DOUBLE-SIDED CYCLE CANOPY | 172/173



TRIANGLE CYCLE CANOPY | 174/175



TRIANGLE DOUBLE-SIDED CYCLE CANOPY | 174/175



FALCOSPAN CYCLE CANOPY | 176/177



FALCOTEL-E CYCLE SHELTER | 178



FALCOTEL-C CYCLE COMPOUND | 179



FALCOTEL-D CYCLE SHELTER | 180



FALCOTEL-K CYCLE STORE | 181



FALCOTEL-L CYCLE CANOPY | 182



FALCOTRUSTIN CYCLE CANOPY | 183



FALCOHOTH CYCLE CANOPY | 184/185



FALCOHOTH DOUBLE SIDED CYCLE SHELTER | 184/185



FALCOZAN-180 CYCLE SHELTER | 186/187



FALCOZAN-360 CYCLE SHELTER | 186/187



FALCOLOK-250 CYCLE STORE | 188



FALCOLOK-300 CYCLE STORE | 189



FALCOLOK-500 CYCLE STORE | 190/191



FALCOLOK-500 BESPOKE CYCLE STORE | 192/193



FALCOLOK-600 CYCLE STORE | 194



FALCOLOK-600 BESPOKE STORE | 195

SMOKING SHELTERS



FALCOQUARTER
SMOKING SHELTER | 196



FALCOSAIL
SMOKING SHELTER | 197



FALCOLITE
SMOKING SHELTER | 198



FALCOLITE DOUBLE-SIDED
SMOKING SHELTER | 199



FALCOBREEZE
SMOKING SHELTER | 200



FALCOSPAN
SMOKING SHELTER | 201



NAVAHO
SMOKING SHELTER | 202



FALCOTRUSTIN
SMOKING SHELTER | 203



FALCOTEL-L
SMOKING SHELTER | 204



FALCOSPAN BESPOKE SHELTER | 205

SECURE STORES, BIN STORES AND STORAGE SHELTERS



FALCOLOK-250
SECURE STORE | 206



FALCOLOK-300
SECURE STORE | 207



FALCOLOK-500
SECURE STORE | 208



FALCOLOK-600
SECURE STORE | 209



FALCOTEL-K
SECURE STORE | 210



FALCOGRAND
STORAGE SHELTER | 211



FALCOROLLER
BUGGY SHELTER | 212



FALCOBOX
STORAGE SHELTER | 213

WALKWAYS, CANOPIES AND CARPORTS



FALCOTRUSTIN
WALKWAY | 214



FALCOTRUSTIN
CARPORT | 214



FALCOPLANA
WALKWAY | 215



FALCOSPAN
WALKWAY | 216



FALCOCREA SECURE STORE | 217





LEA BRIDGE ROAD, LONDON UK

WHAT’S A CYCLE HUB?

In the UK ‘Cycle Hubs’ is a relatively new concept and is a development of the recent growth in cycling.

Essentially, a cycle hub is a cycling centre around which various facilities come together: e.g. cycle parking, bike repair facilities, cycling information - a multiple of services to support the cyclist. A core element is usually cycle parking and Falco has been at the forefront of developing this concept over the last few years.

Falco - The Home of Cycle Hubs

Falco has been designing, manufacturing, supplying and installing mass cycle parking facilities for over 65 years. With a Dutch parent company, Falco brings the whole wealth of European knowledge and understanding to it’s European operations providing best practise and unrivalled experience.



Falco provide a comprehensive free design service using dynamic AutoCAD blocks and rendering images to help clients visualise their cycle hub design. 3D rendering graphics are available for all of our cycle hub designs with both internal and external perspectives available.

All rendering graphics can be incorporated onto real time photos to provide a bona fide perspective of the cycle hub in real life.



THE DESIGN

Whether manned or unmanned, when thinking of cycle hub design, you need to consider what services you wish to provide to the user. Our experience has taught us that there are four core elements to consider when designing a cycle hub:

1. Information

A key part of any public service is giving the user good information - make life easy for the cyclist!

- Branding
- Signage
- Information Point

2. Security and Safety

This is core thinking for any cyclist – am I safe? will my bike be safe? If you want people to use the hub, then this is a key aspect, consider the following:

- Location
- Visibility
- Building Design
- Access Types
- CCTV
- Lighting
- Help Point
- Cycle Racks

3. User Facilities

What’s the difference between a cycle park anda cycle hub? It’s the additional facilities on offer! What standard of facility could you provide your cyclists?

Perhaps consider some of the following key facilities:

- Cycle Parking
- Helmet / General Lockers
- Pump
- Bike Repair Station
- Litter Bins
- Seating
- Vending Machine

4. Practicalities

This is the reality check, the small print if you like. Of course there is the important matter of budgets and what is affordable. It is this which drives most things today, but it is important to factor in issues such as: topographical surveys, planning requirements and other restrictions.



DERBY MIDLAND STATION, UK



LEYTONSTONE STATION, UK



DEWSBURY RAILWAY STATION, UK

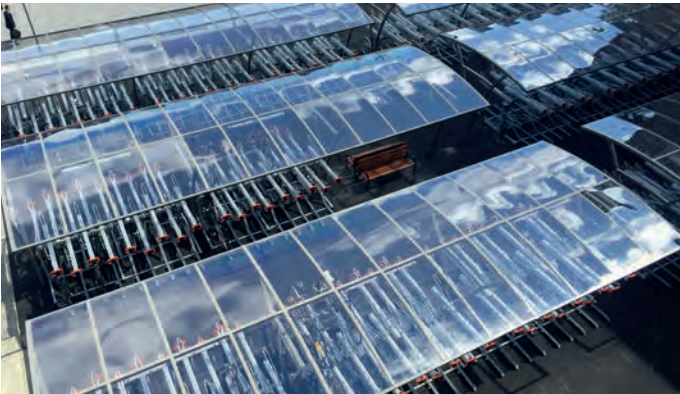

READING STATION, UK



FALCOQUARTER

FALCOQUARTER CYCLE SHELTER

The FalcoQuarter is one of Falco’s most versatile shelter designs. Developed to meet the needs of community projects where budget is the main constraint, the FalcoQuarter offers great flexibility and quality but for minimum cost.

Ideal as a cycle shelter, smoking shelter, waiting shelter or teen shelter, the FalcoQuarter is available in a wide range of options with bays in 2m, 3m, 4m and 5m variants enabling any size of shelter to be created. The simple design lines mean that the shelter can look inconspicuous if necessary by blending in with all surroundings.

The steelwork is hot-dip galvanised to BS EN ISO 1461.

Additionally the cycle shelter can be polyester powder coated in any of the 192 colours of the RAL register to match a scheme or corporate colour.

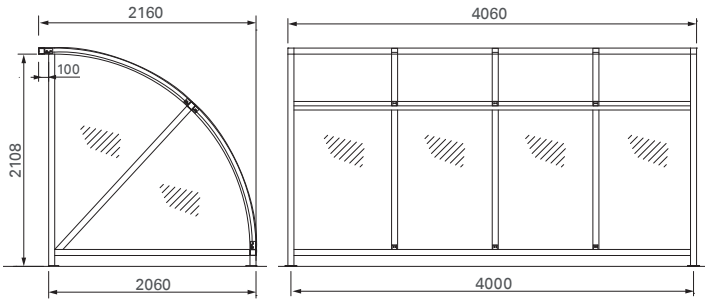

FalcoQuarter, part code 78.409.050 + 78.449.052



FALCOQUARTER | with FalcoToaster Rack
<page 116/117>

FALCOQUARTER-S

Falco has received a number of requests from customers enquiring if it was possible to provide a shelter which can handle an increased snow load. The variation known as the ‘FalcoQuarter-S’ has a maximum load capacity of 200kg per square meter. The aesthetics of the FalcoQuarter-S are the same as the traditional FalcoQuarter.

FALCOQUARTER CYCLE COMPOUND

With the addition of a simple walkway cover and optional gates front and rear, the FalcoQuarter can easily be made into a very versatile storage compound. Again with up to 5m variants, it is possible to create an enclosed, weather-proof space of any size. The front and rear entrance/exits can be left open or closed off. Using robust metal gates and polycarbonate sheets it is simple to create a secure compound which is lockable, yet visible.



FALCOQUARTER | cycle compound with walkway door of bar fencing with hinge

FALCOQUARTER	
PART CODE	DESCRIPTION
78.409.050*	starter section, length 4,000mm
78.449.052	end wall in 5mm clear polycarbonate
78.469.040	walkway cover for starter section 4,000mm, with polycarbonate covering
78.489.211	walkway closing pane
78.499.211	walkway door of bar fencing with right hinge
78.499.221	walkway door of bar fencing with left hinge

FALCOQUARTER-S	
PART CODE	DESCRIPTION
78.409.050S*	starter section, length 4,000mm
78.449.052	end wall in 5mm clear polycarbonate

*All steelwork can be powder coated in any of the 192 standard RAL colours upon request, simply add ‘PC’ to the start of any part code(s) listed to the left.



FALCOQUARTER-C | suitable for a snow load up to 200 kg/m2

FALCOQUARTER CYCLE COMPOUND





FALCOSAIL CYCLE SHELTER

The FalcoSail is a design led product and from any angle the likeness of a sail ship is unmistakable, making the shelter a very attractive addition for any purpose including a cycle shelter, waiting shelter or smoking shelter.

With 3m, 4m and 5m options, there is great scope to extend this shelter which can hold upwards of 8 cycles in an impressive design led solution. Like all Falco shelters, the FalcoSail is modular in design enabling a shelter to be built up to house any number of cycles in various combinations. As with the FalcoLite and FalcoQuarter it is possible to create a ‘combi’ style of compound or walkway by placing bays of FalcoSail facing each other.

The use of a walkway cover and lockable gates between the bays ensures a weatherproof space for housing; cycles, pushchairs, motorcycles or practically anything else.

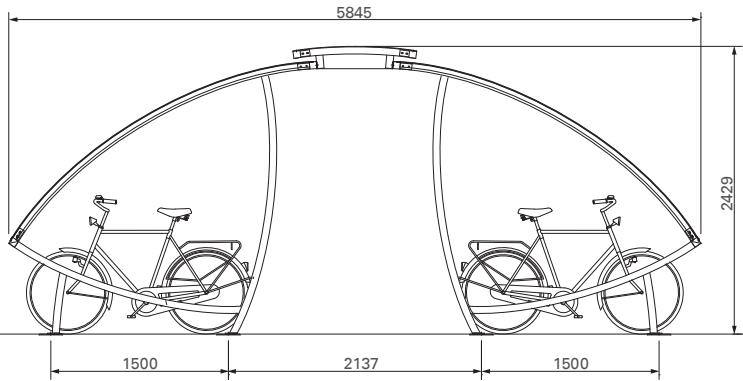

FalcoSail with walkway cover



FALCOSAIL | single sided with an add-on section, steelwork powdercoated



FALCOSAIL | single sided with Trespa end walls (Trespa on request)



FALCOSAIL | with walkway cover and lockable door

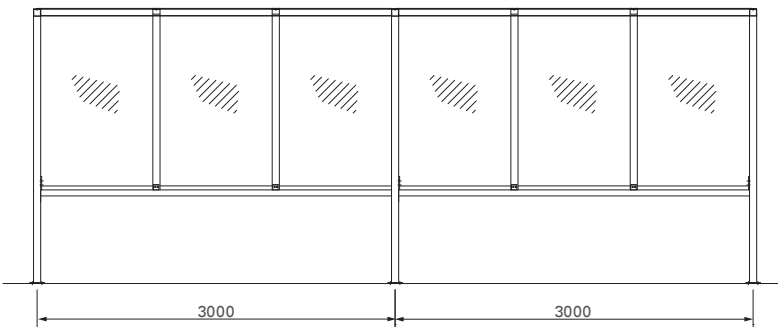

FalcoSail, single sided starter section + single sided add-on section

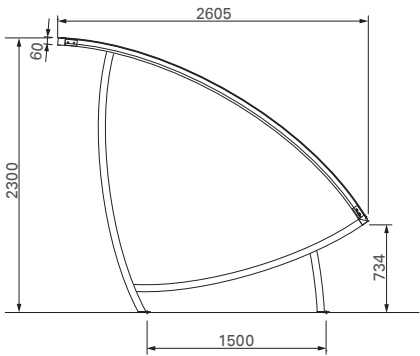

FALCOSAIL	
PART CODE	DESCRIPTION
77.309.040	starter section, length 3,000mm
PC77.309.040	starter section, length 3,000mm, steelwork powder coated in RAL ____
77.319.040	add-on section, length 3,000mm
PC77.319.040	add-on section, length 3,000mm, steelwork powder coated in RAL ____
77.409.040	starter section, length 4,000mm
PC77.409.040	starter section, length 4,000mm, steelwork powder coated in RAL ____
77.419.040	add-on section, length 4,000mm
PC77.419.040	add-on section, length 4,000mm, steelwork powder coated in RAL ____
77.559.050	starter section, length 5,000mm
PC77.559.050	starter section, length 5,000mm, steelwork powder coated in RAL ____
77.569.050	add-on section, length 5,000mm
PC77.569.050	add-on section, length 5,000mm, steelwork powder coated in RAL ____
77.369.050	walkway cover with roof of clear polycarbonate
77.449.052	end wall in 5mm clear polycarbonate

All steelwork is hot dip galvanised to BS EN ISO 1461 and can be polyester powder coated in a RAL colour.



FALCOLITE

FALCOLITE CYCLE SHELTER

The FalcoLite is our flagship shelter – stylish and functional. From housing 8 cycles in a simple 1 bay unit to providing mass cycle parking, the possibilities are endless using the modular nature of the FalcoLite.

Available in three distinct variants; single sided <page 158/159>, double sided <page 160> or combi <page 161>, the FalcoLite is not only a robust and flexible shelter it is also very attractive and highly cost effective. With different roof and side wall options it is capable of combining with most cycle racks or benches, the FalcoLite is our most flexible and popular shelter.

The FalcoLite cycle shelter incorporates integral gutters so that when used as a cycle shelter, there is no rain dripping at the entrance of the shelter. As with all Falco cycle shelters,

as a stand alone, bolt down unit, it is simple to install and under normal operations will remain maintenance free - creating a very low cost of ownership.

By simply adding a cycle rack, Sheffield Stand or Toaster Rack from Falco’s comprehensive cycle parking range creates an attractive, matching cycle shelter arrangement. The FalcoLite can be used as a smoking shelter <page 198/199> complete with bench and ashtray.



FALCOLITE | Trespa end wall and door (on request)

FALCOLITE SINGLE SIDED

The FalcoLite single bay unit is a simple, classic shelter. The single bay combines strength with great design lines. A single unit can be easily extended using ‘add-on’ units to create a continuous line of covered shelter as far as required.

FALCOLITE SINGLE SIDED	
PART CODE	DESCRIPTION
76.309.050	starter section, 3,000mm long
PC76.309.050	starter section, 3,000mm long,
	steelwork powder coated in RAL ____
76.319.050	add-on section, 3,000mm long
PC76.319.050	add-on section, 3,000mm long,
	steelwork powder coated in RAL ____
76.349.052	end wall closed in clear polycarbonate

All steelwork on the FalcoLite shelter is hot dip galvanised to BS EN ISO 1461 and can be polyester powder coated in any of the 192 RAL colours.

The FalcoLite can also be used as a smoking shelter or waiting shelter using any of Falco’s seating, litter bin or ashtray products.



FALCOLITE | single sided

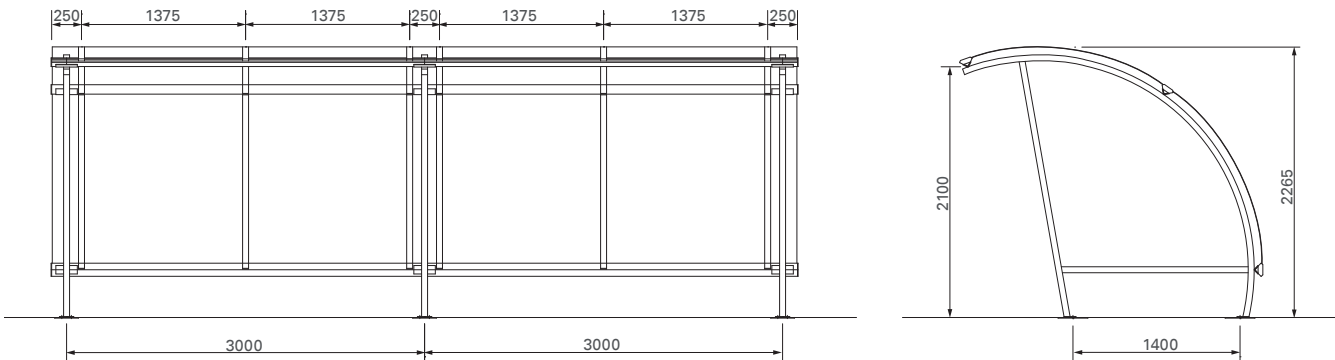

FalcoLite, part code 76.309.050 + 76.319.050



FALCOLITE DOUBLE SIDED

The FalcoLite Double Sided version of the shelter brings two FalcoLite shelters back to back in an attractive ‘Gull wing’ effect. Where access is at a premium, this design creates an ‘island’ effect enabling cycles to be parked double sided with either double sided racks or single units placed back to back.

All steelwork is hot dip galvanised to BS EN ISO 1461 and can be polyester powder coated in a RAL colour.



FALCOLITE | 1 starter section + 1 add-on section

FALCOLITE DOUBLE SIDED	
PART CODE	DESCRIPTION
76.409.050	starter section, 3,000mm long
PC76.409.050	starter section, 3,000mm long, steelwork powder coated in RAL ____
76.419.050	add-on section, 3,000mm long
PC76.419.050	add-on section, 3,000mm long, steelwork powder coated in RAL ____
76.449.052	end wall in 1 part, polycarbonate

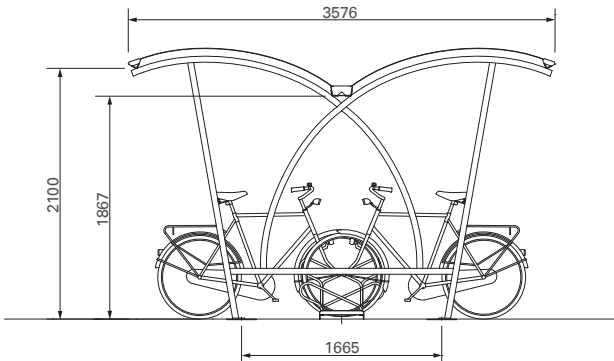

FalcoLite, part code 76.409.050



FALCOLITE CYCLE COMPOUND

A useful combination is to create a cycle compound with cycle parking each side by placing two FalcoLite’s facing each other. Compounds have the advantage of providing wide coverage whilst retaining maximum visibility. By providing an optional walkway cover down the middle or panels at each end it is possible to create a fully enclosed area.

All steelwork is hot dip galvanised to BS EN ISO 1461 and can be polyester powder coated in a RAL colour.



FALCOLITE | with walkway cover

FALCOLITE COMBI	
PART CODE	DESCRIPTION
76.369.050	walkway canopy, base section, with clear polycarbonate covering
76.379.050	walkway canopy, add-on section, with clear polycarbonate covering
76.389.052	walkway closure of polycarbonate covering, delivery together with the shelter
76.390.052	walkway covering with single revolving door of polycarbonate, delivery together with the shelter

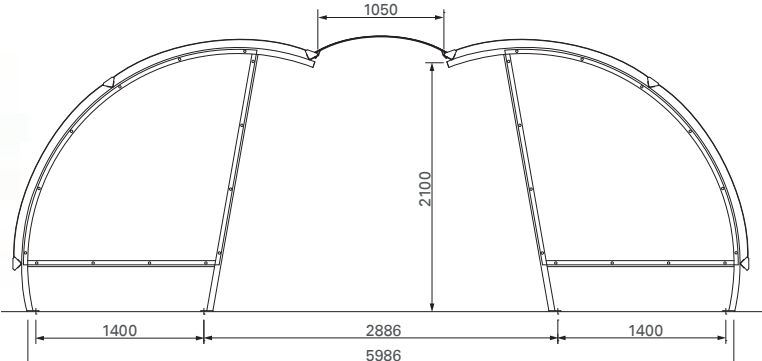

FalcoLite 2x part code 76.309.050 + 1x part code 76.369.050



FALCOBREEZE

FALCOBREEZE CYCLE CANOPY

The FalcoBreeze canopy is a great application for areas of a higher density. Increasingly on busy streets and walkways, sign posts and street furniture are reducing the amount of available spaces for pedestrians to walk, so the FalcoBreeze canopy creates a great overhead canopy area whilst occupying a minimum of floor space.

The FalcoBreeze is available in 2m, 3m, 4m and 5m variants.

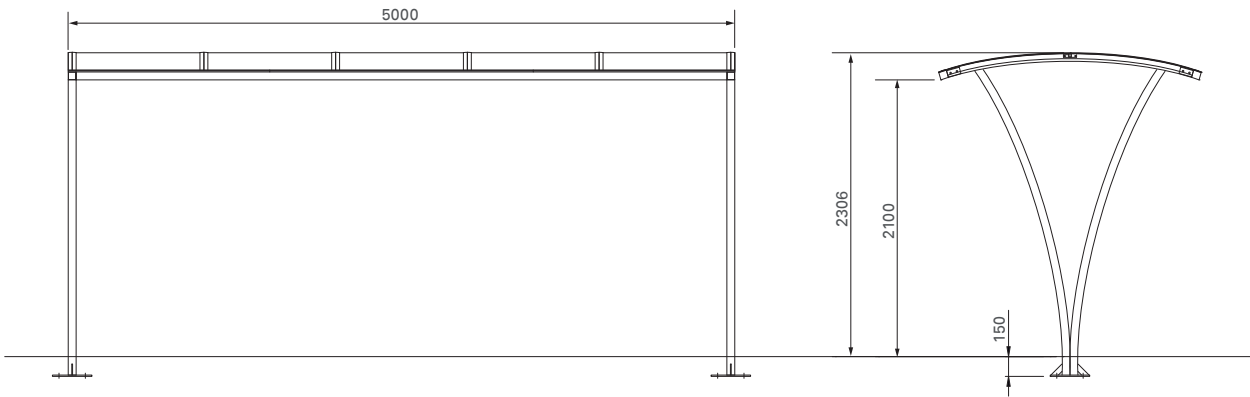

FalcoBreeze starter section, part code 72.509.050



FALCOBREEZE WITH FALCOTOASTER page 118/119



FALCOBREEZE, steelwork powder coated

All steelwork on the FalcoBreeze canopy is hot dip galvanised to BS EN ISO 1461 and can be polyester powder coated in any of the 192 standard RAL colours to match a corporate colour.

FALCOBREEZE	
PART CODE	DESCRIPTION
72.209.050	starter section, length 2,000mm
PC72.209.050	starter section, length 2,000mm, steelwork powder coated in RAL ____
72.219.050	add-on section, length 2,000mm
PC72.219.050	add-on section, length 2,000mm, steelwork powder coated in RAL ____
72.309.050	starter section, length 3,000mm
PC72.309.050	starter section, length 3,000mm, steelwork powder coated in RAL ____
72.319.050	add-on section, length 3,000mm
PC72.319.050	add-on section, length 3,000mm, steelwork powder coated in RAL ____
72.409.050	starter section, length 4,000mm
PC72.409.050	starter section, length 4,000mm, steelwork powder coated in RAL ____
72.419.050	add-on section, length 4,000mm
PC72.419.050	add-on section, length 4,000mm, steelwork powder coated in RAL ____
72.509.050	starter section, length 5,000mm
PC72.509.050	starter section, length 5,000mm, steelwork powder coated in RAL ____
72.519.050	add-on section, length 5,000mm
PC72.519.050	add-on section, length 5,000mm, steelwork powder coated in RAL ____



FALCORAIL LOW, SINGLE SIDED

FALCORAIL LOW CYCLE CANOPY

The FalcoRail-Low is derived from our best selling FalcoRail cycle canopy <page 162/163> and offers the same distinctive design characteristics, but in a sleeker and more cost-effective design. The FalcoRail-Low has maximum shelter coverage whilst occupying minimum floor spaces and can be used for a huge variety of cycle rack and stand designs including the popular A-11 rack <page 122/123>, Sheffield Cycle Stand <page 110-113>, Toast rack <page 116/117> and many more.

The FalcoRail-Low canopy is available in both single and double sided versions and with the use of add-on sections,

it is possible to create a continuous shelter run as long as required.



FALCORAIL LOW, SINGLE SIDED

FALCORAIL LOW SINGLE SIDED	
PART CODE	DESCRIPTION
73.309.250*	single sided, 3m long starter section
73.319.250*	single sided, 3m long add-on section
73.409.250*	single sided, 4m long starter section
73.419.250*	single sided, 4m long add-on section
73.509.250*	single sided, 5m long starter section
73.519.250*	single sided, 5m long add-on section

FALCORAIL LOW DOUBLE SIDED	
PART CODE	DESCRIPTION
73.359.250*	double sided, 3m long starter section
73.369.250*	double sided, 3m long add-on section
73.459.250*	double sided, 4m long starter section
73.469.250*	double sided, 4m long add-on section
73.559.250*	double sided, 5m long starter section
73.569.250*	double sided, 5m long add-on section

All steelwork can be powder coated in any of the 192 standard RAL colours upon request, simply add 'PC' to the start of any part code(s) listed to the right.

The roof sheets are manufactured from transparent polycarbonate which is 250 times stronger than glass.

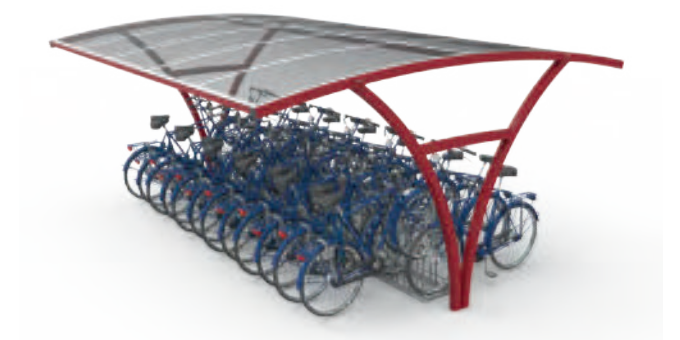

FALCORAIL LOW, DOUBLE SIDED

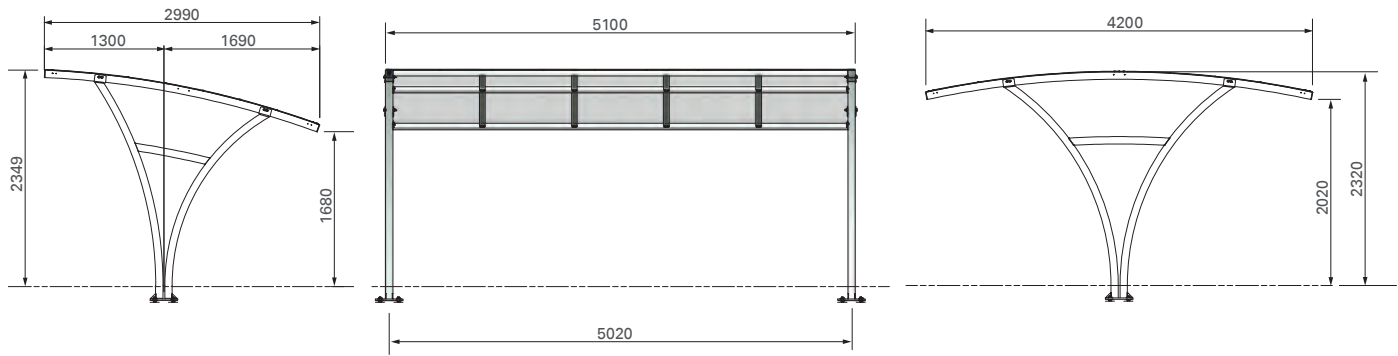

FalcoRail Low starter section, single sided FalcoRail Low starter section, double sided



FALCORAIL CYCLE CANOPY

The FalcoRail is an exceptionally attractive and modular cycle canopy design.

Available in both single or double sided units in 2m, 3m, 4m and 5m lengths, the cycle canopy is ideal for accommodating all cycle racks as well as the innovative FalcoLevel Premium+ two-tier rack <page 130-133>.

With a significant depth, the canopy provides maximum coverage whilst occupying minimum space. The FalcoRail can be positioned side by side to create a continuous run of virtually any length or to accommodate a specific number of bicycles.

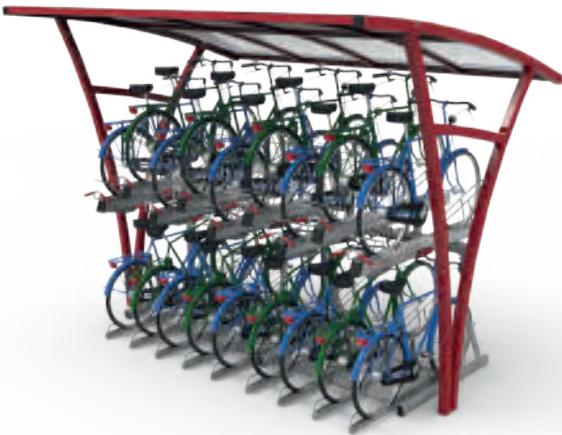

FALCORAIL, SINGLE SIDED

All steelwork can be powder coated in any of the 192 standard RAL colours upon request, simply add 'PC' to the start of any part code(s) listed to the right.

FALCORAIL SINGLE SIDED	
PART CODE	DESCRIPTION
73.209.050*	single sided, 2m long starter section
73.219.050*	single sided, 2m long add-on section
73.309.050*	single sided, 3m long starter section
73.319.050*	single sided, 3m long add-on section
73.409.050*	single sided, 4m long starter section
73.419.050*	single sided, 4m long add-on section
73.509.050*	single sided, 5m long starter section
73.519.050*	single sided, 5m long add-on section



FALCORAIL, SINGLE SIDED

FALCORAIL DOUBLE SIDED	
PART CODE	DESCRIPTION
73.259.050*	double sided, 2m long starter section
73.269.050*	double sided, 2m long add-on section
73.359.050*	double sided, 3m long starter section
73.369.050*	double sided, 3m long add-on section
73.459.050*	double sided, 4m long starter section
73.469.050*	double sided, 4m long add-on section
73.559.050*	double sided, 5m long starter section
73.569.050*	double sided, 5m long add-on section



FALCORAIL, DOUBLE SIDED

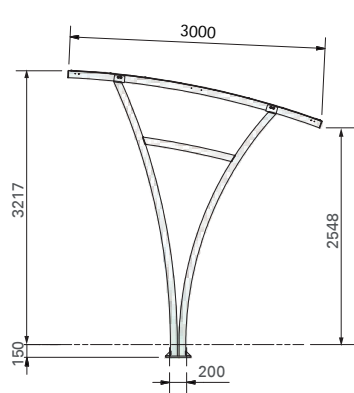

FalcoRail starter section, single sided

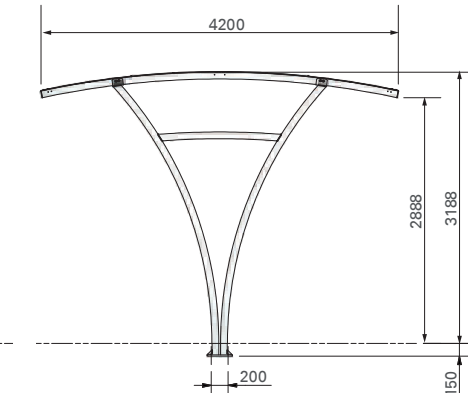
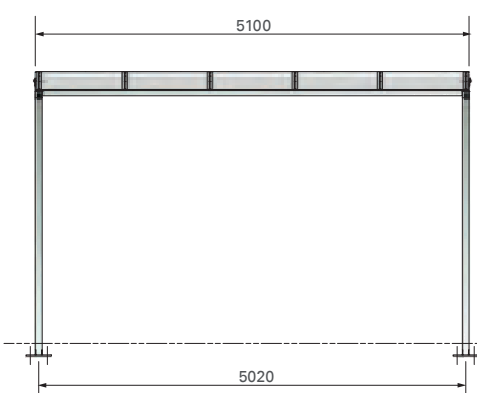

FalcoRail starter section, double sided



FALCOGAMMA SINGLE SIDED

A design characteristic for this model is the central column that evolves into two upward facing branches. The name Gamma was chosen because, when viewed from the side, the shape of the structure looks like the Greek letter gamma



FALCOGAMMA | single sided canopy

and underlines the design statement that we wanted to make with this new shelter.

FalcoGamma is available in both single sided and double sided versions. The FalcoGamma is an elegant addition to the constantly evolving Falco product line.

The single sided canopy creates a 1.9 metre span ideal for cycle parking or as a walkway canopy.

The canopy has a free head height of 2,100mm - perfect for a huge range of cycle parking systems.

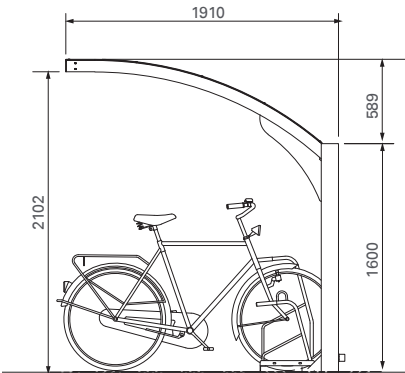

FalcoGamma, part code 77.759.050



Side walls

There are also optional side walls (as shown below) which can be fitted if required, The sidewalls are manufactured from 4mm thick polycarbonate sheet which is fixed with glass clamps between the stanchions.



FALCOGAMMA | single sided

FALCOGAMMA SINGLE SIDED	
PART CODE	DESCRIPTION
77.759.350*	single sided starter section, with polycarbonate sheets, length 3,000mm, below ground fix
77.769.350*	single sided add-on section, with polycarbonate sheets, length 3,000mm, below ground fix
77.759.351*	single sided starter section, with polycarbonate sheets, length 3,000mm, on baseplates
77.769.351*	single sided add-on section with polycarbonate sheets, length 3,000mm, on baseplates
77.759.050*	single sided starter section, with polycarbonate sheets, length 4,000mm, below ground fix
77.769.050*	single sided add-on section, with polycarbonate sheets, length 4,000mm, below ground fix
77.759.051*	single sided starter section, with polycarbonate sheets, length 4,000mm, on baseplates
77.769.051*	single sided add-on section with polycarbonate sheets, length 4,000mm, on baseplates

*All steelwork can be powder coated in any of the 192 standard RAL colours upon request, simply add 'PC' to the start of any part code(s) listed above.



FALCOGAMMA DOUBLE SIDED

The double sided FalcoGamma creates a majestic tree design when viewed in elevation. Tip to tip, the overall span of the canopy is 3,700mm with a free head height of 2,100mm at the front.



FALCOGAMMA | double sided, powdercoated

The arched arms cause rainwater to run into the central integral gutter and the waste water is discharged at ground level via internal drainage.

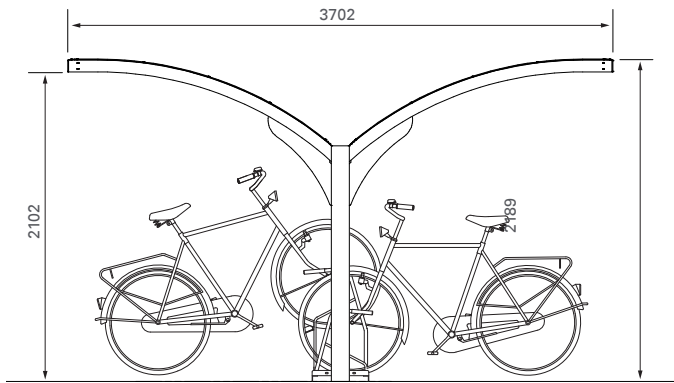

FalcoGamma double sided, part code 77.859.051



Side walls

There are also optional side walls (as shown below) which can be fitted if required, The sidewalls are manufactured from 4mm thick polycarbonate sheet which is fixed with glass clamps between the stanchions (it can also be delivered with safety glass if preferred).



FALCOGAMMA DOUBLE SIDED	
PART CODE	DESCRIPTION
77.859.350*	double sided, starter section, length 3,000mm, below ground fix
77.869.350*	double sided, add-on section, length 3,000mm, below ground fix
77.859.351*	double sided, starter section, length 3,000mm, on base plates
77.869.351*	double sided, add-on section, length 3,000mm, on base plates
77.859.050*	double sided, starter section, length 4,000mm, below ground fix
77.869.050*	double sided, add-on section, length 4,000mm, below ground fix
77.859.051*	double sided, starter section, length 4,000mm, on base plates
77.869.051*	double sided, add-on section, length 4,000mm, on base plates

*All steelwork can be powder coated in any of the 192 standard RAL colours upon request, simply add 'PC' to the start of any part code(s) listed above.



FALCOGAMMA 2HI

Compact cycle parking is the ideal solution when there is a requirement to provide mass cycle parking or where space is at a premium.

The FalcoGamma 2Hi is derived from the popular FalcoGamma cycle canopy <page 168-171> and offers the same design characteristics but with an increased height to accommodate the flagship FalcoLevel-Premium+ two-tier cycle parking system <page 130-133>.

The FalcoGamma 2Hi can be positioned side by side to create a continuous run of virtually any length or to accommodate a specific number of cycles.

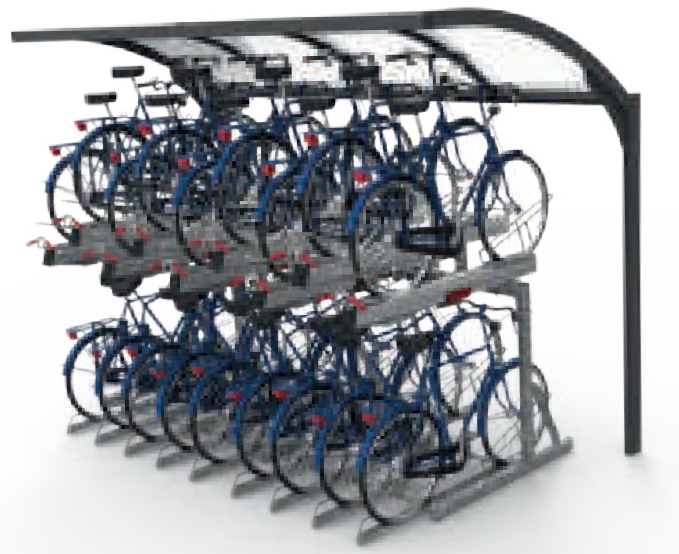

The FalcoGamma 2Hi is an exceptionally attractive and open cycle canopy design offering maximum shelter coverage whilst occupying minimum floor space.

The canopy is available in both single and double sided variants and is suitable for accommodating all Falco cycle parking systems as well as the innovative two-tier cycle rack.

The cycle canopy is manufactured from 100% recyclable hot-dip galvanised steel and polycarbonate roof sheets. The steelwork can be polyester powder coated in any of the 192 standard RAL colours upon request.



FALCOGAMMA 2Hi | with FalcoLevel Premium+ two-tier cycle rackS <page 130-133>

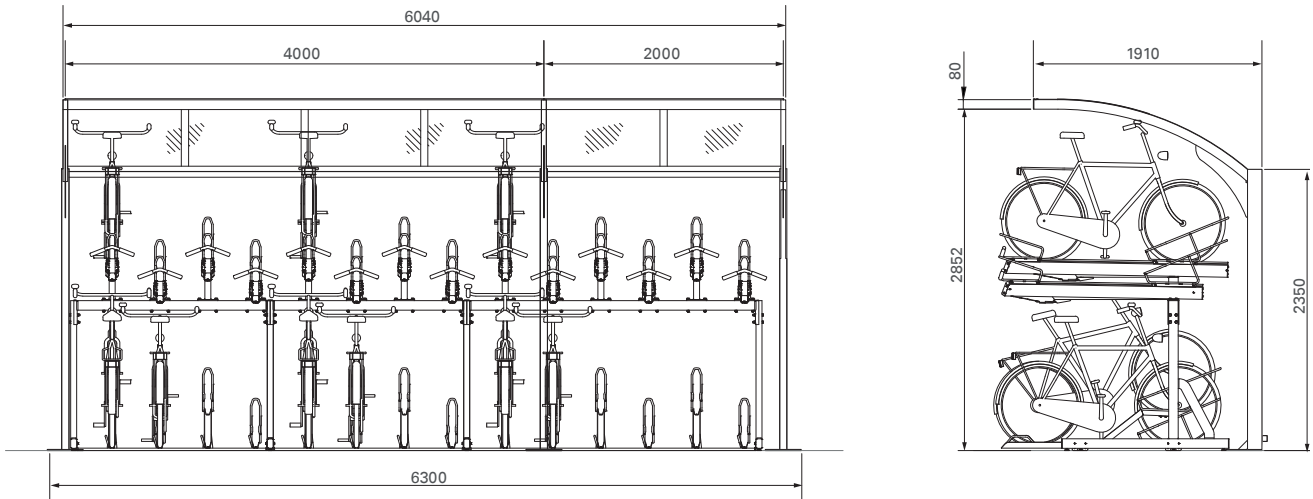

FalcoGamma 2Hi single sided, providing 28 spaces of FalcoLevel Premium+



TRIANGLE CYCLE CANOPY

The Triangle canopy system is part of a co-ordinated range of street furniture products <page 14/15> which also includes cycle stands <page 114 and 118/119>.

The shelter brings the familiar design led ‘triangle’ theme to the fore and the use of a range of materials including stainless steel and powdercoated galvanised steel with roof cladding options of aluzinc or safety glass.

As with all Falco products, the aesthetic strengths of the design are matched by high functionality. The canopy incorporates integrated gutters with rainwater being channelled inside the structure and discharged at ground level.

Additionally lighting can be incorporated into the central panel of the canopy with opaque acrylic covering. Optional back and side wall panels include steel sheet or safety glass.



TRIANGLE | single sided with aluzinc roof sheets and sendzimir galvanised wall panel with Triangle cycle stands <page 118/119>

TRIANGLE, SINGLE SIDED	
PART CODE	DESCRIPTION
68.000.000	single sided starter section, roof of aluzinc sheets
68.010.000	single sided add-on section, roof of aluzinc sheets
68.020.017	back wall with 5 aluzinc sheets
68.040.017	side wall of sendzimir galvanised sheets
68.050.017	side wall, stater element with 2 uprights
	and a aluzinc sheet
68.100.000	single sided starter section, roof of aluzinc sheets, including lighting
68.110.000	single sided add-on section, roof of aluzinc sheets, including lighting
68.200.172	single sided starter section, roof of safety glass
68.210.172	single sided add-on section, roof of safety glass
68.300.172	single sided starter section, roof of safety glass, including lighting
68.310.172	single sided add-on section, roof of safety glass, including lighting

TRIANGLE, DOUBLE SIDED	
PART CODE	DESCRIPTION
68.500.000	double sided starter section, roof of aluzinc sheets
68.510.000	double sided add-on section, roof of aluzinc sheets
68.040.017	side wall of sendzimir galvanised sheets
68.600.000	double sided starter section, roof of aluzinc sheets, including lighting
68.610.000	double sided add-on section, roof of aluzinc sheets, including lighting
68.700.172	double sided starter section, roof of safety glass
68.710.172	double sided add-on section, roof of safety glass
68.800.172	double sided starter section, roof of safety glass, including lighting
68.810.172	double sided add-on section, roof of safety glass, including lighting



TRIANGLE | double sided with roof manufactured from safety glass and Ideal cycle racks <page 120/121>

Again there is a double sided canopy option making the Triangle a very versatile unit. By placing two units facing each other a covered walkway or compound can be created. Utilising the 2.25m span for each arm, a walkway 4,000m wide is possible - ideal for a public thoroughfare.

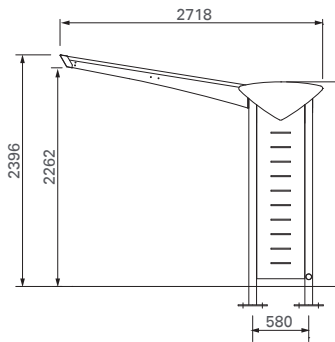

Triangle, part code 68.000.000 / 68.200.172

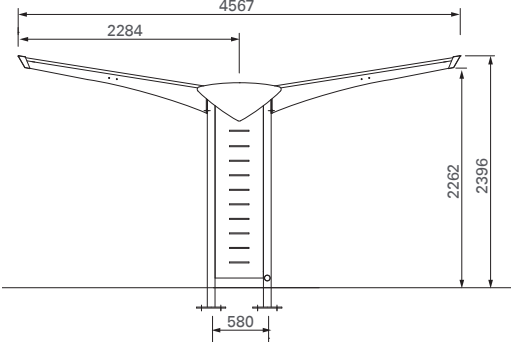
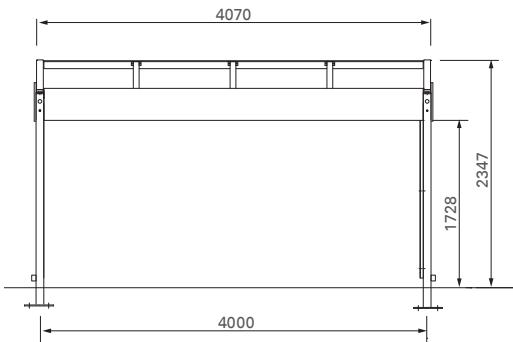

Triangle, part code 68.500.000 / 68.700.172



FALCOSPAN CYCLE CANOPY

FALCOSPAN CYCLE CANOPY

The FalcoSpan series of canopies offers great flexibility when providing an uncomplicated weather shelter. An exceptionally attractive and open shelter, very simple construction and great aesthetics. Useful for smoking shelters <pages 196-204>, walkways, canopies, cycle shelters and general waiting areas, the FalcoSpan can cover every option.

The cantilevered design is topped with a robust roof section which contains integral gutters enabling waste water to be discharged at ground level via the supporting uprights. The standard roof sheets are in aluzinc corrugated metal, but other options are available in polycarbonate if you require light to reach in.

The FalcoSpan shelter is available with optional side panels to create a closed shelter. The panels of safety glass are mounted on the canopy uprights and provide great weather protection whilst allowing maximum visibility.

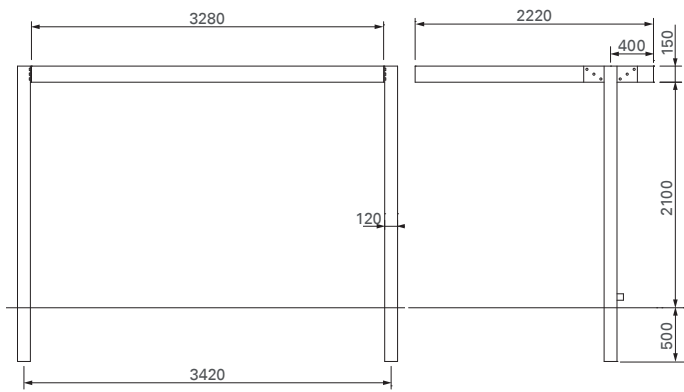

FalcoSpan, part code 21.025.000 + 21.144.000L + 21.144.000R

FALCOSPAN	
PART CODE	DESCRIPTION
21.023.000	roof, 2,220x2,220mm (without uprights)
21.024.000	roof, 2,750x2,220mm (without uprights)
21.025.000	roof, 3,280x2,220mm (without uprights)
21.026.000	roof, 3,810x2,220mm (without uprights)
21.027.000	roof, 4,340x2,220mm (without uprights)
21.028.000	roof, 4,870x2,220mm (without uprights)
21.029.000	roof, 5,400x2,220mm (without uprights)
21.144.000L	left starter/end supporting column 120x120mm, to grout in
21.144.000R	right starter/end supporting column 120x120mm, to grout in
21.144.000T	intermediary supporting column 120x120mm, to grout in
21.152.000	prefab roof joining frame when using 21.144.000T

All steelwork is hot dip galvanised to BS EN ISO 1461 and can be polyester powder coated in any of the 192 RAL colours.



FALCOSPAN | with A-11 cycle racks <page 122/123>



SPECIAL FALCOSPAN | with Sheffield stands <page 110-113> and wooden cladding around the uprights





BESPOKE FALCOTEL CYCLE SHELTER

FALCOTEL CYCLE SHELTER

The FalcoTel family offer a number of different cycle shelter variations including a simple open cycle shelter design using the FalcoTel-E, a double-sided unit using the FalcoTel-D, a secure lockable store using the FalcoTel-K <page 181> and a wall mounted canopy using the FalcoTel-L <page 182>.

The pitched roof means all rain water is directed towards the rear of the store and away from the door areas.

FALCOTEL-E CYCLE SHELTER

This is the basic building block of the range with uprights and a roof section - a very affordable and simple design. By adding back and side walls, the FalcoTel-E can be supplied with optional cladding in hardwood, corrugated metal sheets or steel mesh to meet various design schemes.



FALCOTEL-E | with back wall with corrugated metal sheeting and end walls with hardwood lattice work

Like most Falco products, the cycle shelter is modular enabling it to be extended as required.



FALCOTEL-E | without back and side walls

FALCOTEL-E	
PART CODE	DESCRIPTION
23.000.000	single sided base section, length 4,000mm
23.000.040	single sided base section, length 4,000mm, with bolt down side frames
23.010.000	single sided add-on section, length 4,000mm
88.825.000	steel drainpipe of 60mm tubing, length 1,500mm
23.020.000	back wall with corrugated metal sheeting
23.028.000	back wall with hardwood lattice work
23.040.000L	left end wall with corrugated metal sheeting
23.040.000R	right end wall with corrugated metal sheeting
23.048.000L	left end wall with hardwood lattice work
23.048.000R	right end wall with hardwood lattice work

FALCOTEL-C CYCLE COMPOUND

As with the FalcoQuarter <page 154/155> and FalcoLite <page 158-161> cycle shelters, the FalcoTel range of shelters and canopies can be transformed into a secure cycle compound by placing two FalcoTel-E shelters face to face to create a fully enclosed cycle compound with optional lighting and lockable gates. This is a great option for increasing security whereby access to the cycle compound can be restricted. With the use of a walkway cover strip ensures the FalcoTel-C is fully weather proof.



FALCOTEL-C

FALCOTEL-C	
PART CODE	DESCRIPTION
23.800.000	combi base section, length 4,000mm
23.810.000	single sided add-on section, length 4,000mm
23.858.000	walkway cover
23.838.000	single door

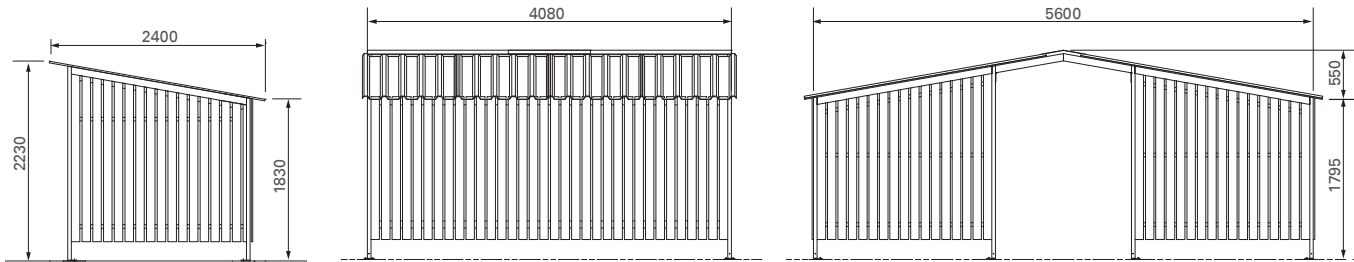

FalcoTel-E, part code 23.000.000 and walls with hardwood lattice work

FalcoTel-C, part code 23.800.000 and walls with hardwood lattice work + 23.858.000



FALCOTEL-D CYCLE SHELTER

The FalcoTel-D is a double sided variant of the FalcoTel-E. With a distinct ‘Y’ shaped section, the FalcoTel-D has great symmetrical lines as well as complimenting the single sided version of the range. As an ‘island’ unit, the FalcoTel-D can be used as a stand alone unit or in rows to create a large storage compound.

The pitched roof sections channels rainwater to the centre of the structure where it is collectected in a gutter and is discharged via a drain pipe to ground level. As with the single sided version, cladding is available for the end panels enabling designers to add playful variations to the scheme. The standard model is 4,000mm between the centres of the uprights and the canopy has a span of 3,700mm.

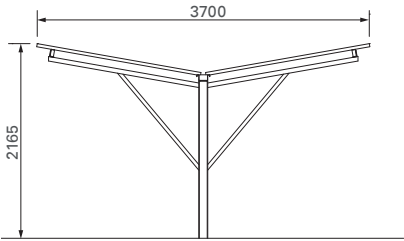

FalcoTel-D, part code 23.500.000



FALCOTEL-D	
PART CODE	DESCRIPTION
23.500.000	double sided base section, length 4,000mm
23.500.040	double sided base section, length 4,000mm, on base plates
23.510.000	double sided add-on section, length 4000mm
23.510.040	double sided add-on section, length 4,000mm, on base plates
88.825.000	steel drainpipe of 60mm tubing, length 1,500mm
23.548.000	end wall with hardwood lattice work, slanting form
23.540.000	prefab side frame with aluzinc and diagonal top



FALCOTEL-K CYCLE STORE

The FalcoTel-K enables the FalcoTel range to become a secure store. At 2,900mm deep, the FalcoTel-K is slightly deeper than the standard range and is ideal for cycle storage, enabling cyclists to maneuver their bikes in and out safely. The store can be clad in a variety of finishes including hardwood slats, corrugated aluzinc sheets or wire mesh. There are a number of permutations for positioning of the door (ask our sales department). Single or double doors are able to be positioned in either the front or side walls. The storage shelter also comes complete with a Europrofile cylinder lock. The roof is manufactured from either aluzinc sheet or corrugated polyester.

FALCOTEL-K	
PART CODE	DESCRIPTION
23.200.000C	with single door DIN left, model C starter section
23.248.000L	prefab side frame on base plates with hardwood slats (large 95mm) and diagonal top, left side
23.248.000C	side wall cladding for FalcoTel-K (door C) with hardwood slats large 95 mm and diagonal top
23.238.000	front wall, with hardwood slats (large 95mm) on steel purlins, length 4,000mm
23.228.000	rear wall, with hardwood slats on steel purlins, length 4,000mm
88.825.000	steel drain pipe of tubing 60mm, length 1,500mm

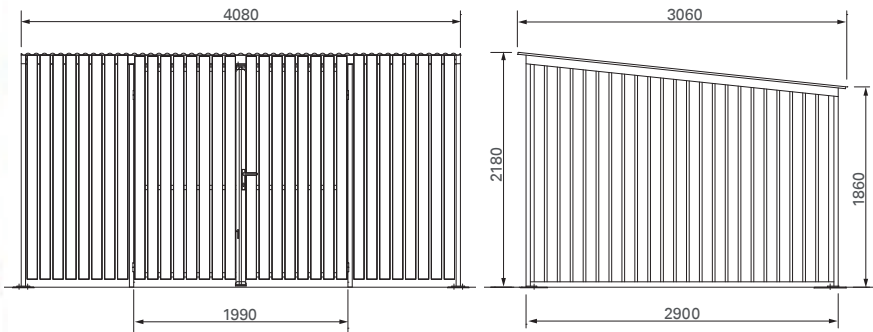

FALCOTEL-K | with double doors



FALCOTEL-L CYCLE CANOPY

The FalcoTel-L is the wall mounted version of the FalcoTel range. A highly economical canopy requiring a sturdy wall for bolting to. The canopy is ideal for use as a cycle shelter, smoking shelter or waiting shelter.

The canopy provides coverage of 4,000mm and is 2,440mm deep, the roof sheets are manufactured from corrugated aluzinc sheets.



FALCOTEL-L | with side walls (on request)

FALCOTEL-L	
PART CODE	DESCRIPTION
23.300.000	starter section, length 4,000mm
23.310.000	add-on section, length 4,000mm
88.823.000	steel drainpipe for FalcoTel-L

It can be mounted at any height from the floor, though a standard distance of 2,095mm is recommended.

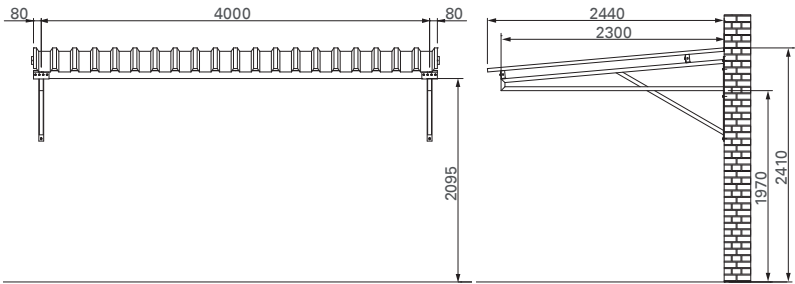

FalcoTel-L, part code 23.300.000



FALCOTRUSTIN CYCLE CANOPY

The FalcoTrustin is a product which offers great flexibility when providing an uncomplicated cycle shelter, smoking shelter or canopy. The canopy is an exceptionally attractive shelter with a very simple construction and great aesthetics.

With standard square roof sections of 1m x 1m and a standard bay length of 4m, the FalcoTrustin can be extended in length up to any dimension - to match any bespoke requirement.

FALCOTRUSTIN	
PART CODE	DESCRIPTION
28.409.050	starter section, length 4,000mm
28.419.050	add-on section, length 4,000mm

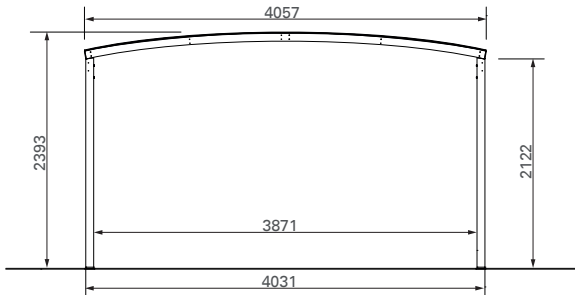

FalcoTrustin, part code 28.409.050

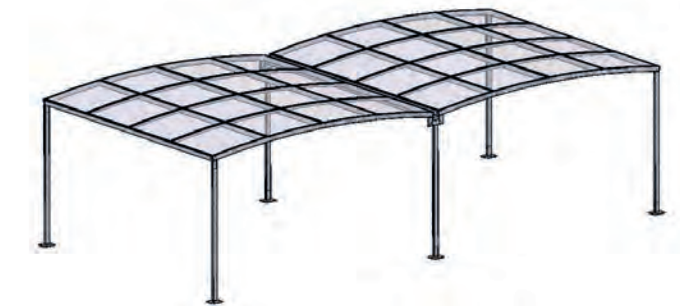

FALCOTRUSTIN



FALCOHOTH CYCLE CANOPY

The FalcoHoth is a purpose designed canopy to withstand large amounts of snow in areas where snow loading is a critical issue. The FalcoHoth is an attractive and reinforced cycle shelter design but with maximum functionality.

The FalcoHoth is manufactured from hot-dip galvanised steel with either steel or safety glass roof panels. The shelter steelwork can be optionally powder coated in any colour from the RAL register upon request.

The shelter features integrated drainage which directs water from the roof and discharges at ground level. The FalcoHoth has a maximum load capacity of 250kg per square metre.

The cantilevered shelter is available in a single sided version to accommodate 10 bikes or a double sided version to accommodate 20 bikes.

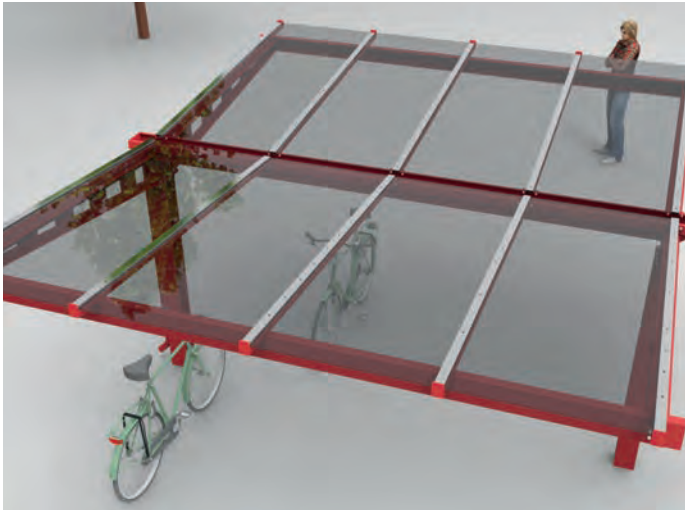

FALCOHOTH, SINGLE SIDED	
PART CODE	DESCRIPTION
28.000.000	starter section, with steel roof plates 106R
28.010.000	add-on section, with steel roof plates 106R
28.000.172	starter section, with glass roof
28.010.172	add-on section, with glass roof

FALCOHOTH, DOUBLE SIDED	
PART CODE	DESCRIPTION
28.100.000	starter section, with steel roof plates 106R
28.110.000	add-on section, with steel roof plates 106R
28.100.172	starter section, with glass roof
28.110.172	add-on section, with glass roof

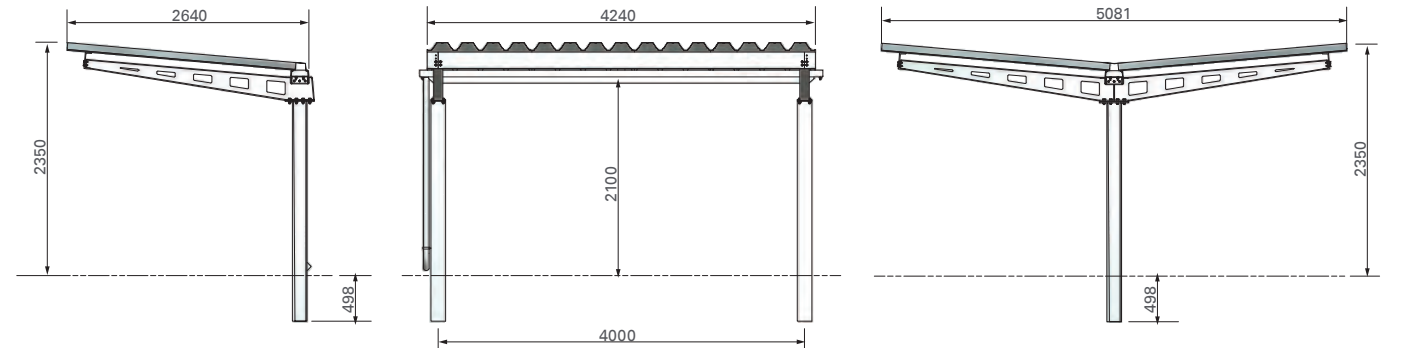

FalcoHoth, part code 28.000.000

FalcoHoth, part code 28.100.000

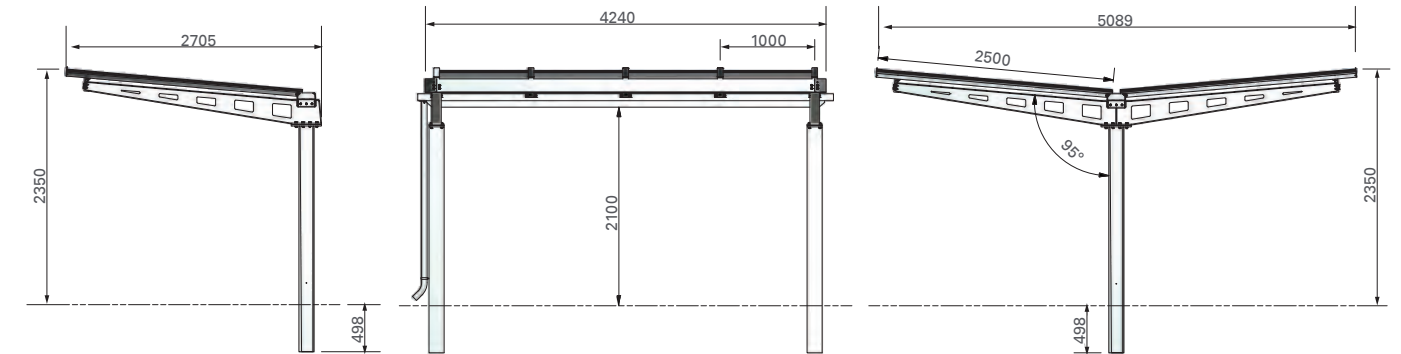

FalcoHoth, part code 28.000.172

FalcoHoth, part code 28.100.172



FALCOZAN-180 CYCLE SHELTER

FALCOZAN CYCLE SHELTER

The FalcoZan range is a neat and simple design of open shelter, ideal for numerous applications. Available in both single and double sided versions, the FalcoZan is a vandal resistant shelter with optional side cladding in hardwood slats, corrugated aluzinc or other finishes on application.

The FalcoZan-180 is the single sided version of the product range. The base module can be added to - to create a shelter as wide as required, by using standard ‘add-on’ units. The FalcoZan-360 is the double sided version of the range. By placing two single shelters back-to-back, it is easily possible to create a 5m deep shelter. Additionally, more shelters can be placed side to side to create a covered area of virtually any size. All steelwork is hot dip galvanised as standard and can be polyester powder coated in a RAL colour.

The roof sheets are manufactured from corrugated aluzinc sheets.

Falco employs its own installation engineers and we can offer full contract management of the supply and installation of the FalcoZan shelter.



FALCOZAN-180 AND FALCOZAN-360

FALCOZAN	
PART CODE	DESCRIPTION
27.003.000	FalcoZan-180 single sided starter section
27.013.000	FalcoZan-180 single sided add-on section
27.423.000	wall in aluzinc sheets 1mm on steel frame
27.428.000	back or side wall in hardwood slats
27.443.000	prefab end wall covering of aluzinc sheets
27.448.000	side wall covering with hardwood lattice work
OND27.000.350	drain pipe for FalcoZan-180
27.103.000	FalcoZan-360 double sided starter section
27.113.000	FalcoZan-360 double sided add-on section
27.443.000	prefab wall covering with alucinz sheets
27.448.000	side wall in hardwood slats
OND27.000.351	drain pipe for FalcoZan-360



FALCOZAN-180 single sided



FALCOZAN-360 double sided

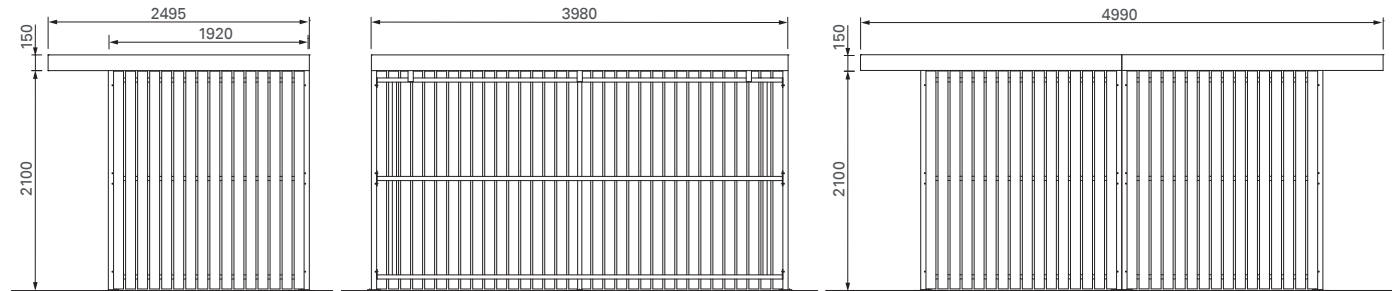

FalcoZan-180, part code 27.003.000 + 27.448.000	part code 27.003.000 + 27.428.000	FalcoZan-360, part code 27.103.000 + 2x 27.448.000
--	-----------------------------------	---

FALCOZAN-180 without side walls





FALCOLOK-250

FALCOLOK-250 CYCLE STORE

The FalcoLok-250 is the smallest product from the FalcoLok range.

There are a huge range of flexible options for the FalcoLok-250 including cladding in over 12 different materials, the relocation of single or double doors, the relocation of the drain pipe and the option of extending in width, length or height.

The store has an overall height of 2,250mm and a free head height of 2,100mm.

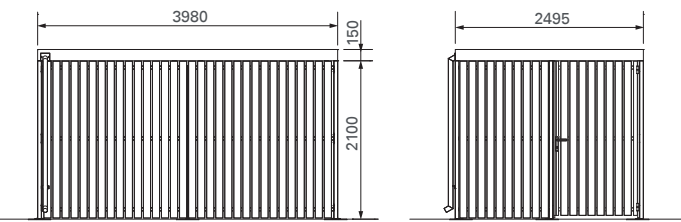

FALCOLOK-250 | with single door

FALCOLOK-250	
PART CODE	DESCRIPTION
27.503.000A	base section, dim. 2,500x3,980mm, height 2100/2250mm, door position A (single door at the 250 cm side DIN right)
OND27.000.350	drainpipe
27.438.000	end wall cladding in standard hardwood
27.408.000	end wall and single door cladding in standard hardwood
27.428.000	side wall in standard hardwood



FALCOLOK-300

FALCOLOK-300 CYCLE STORE

The FalcoLok-300 is a larger variant of the FalcoLok range measuring 3,120mm at the front x 3,980mm deep.

The height is the same as for all the FalcoLok products - 2,250mm overall height and 2,100mm free head height.

There are a huge range of additional options for the FalcoLok range including specific dimensions in length, width and height as well as over 12 cladding options, numerous locking mechanisms, relocation of single or double doors, clear roofing options and numerous drainage positions.

The roof sheets of the FalcoLok series are standard 1mm thick aluzinc, creating a robust and long lasting store. The rainwater on the sheets is directed into the roof fascia which channels the water to drainpipes for the dispersion of water to ground level.

All steelwork on the FalcoLok series is hot dip galvanised to BS EN ISO 1461 and can be additionally powder coated in any of the 192 RAL colours if required.

FALCOLOK-300	
PART CODE	DESCRIPTION
27.553.000D	base section, dim. 3,120x3,980mm, height 2100/2250mm, with double door in the 312cm side
OND27.000.351	drainpipe for 2 roof sections
27.428.000	steel side frames including standard hardwood cladding
27.448.000	end wall covering in standard hardwood
27.458.000	walkway shut including standard hardwood cladding
27.558.000	cladding in standard hardwood for end wall and double doors in standard hardwood

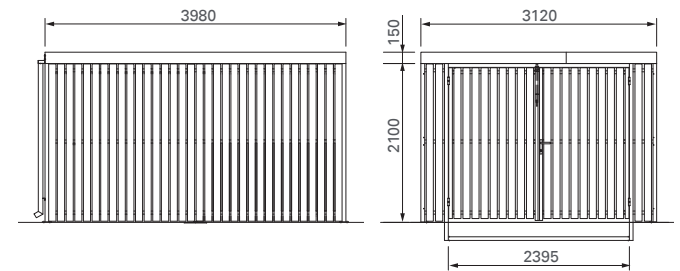

FalcoLok-300 with double door



FALCOLOK-500 CYCLE STORE

The FalcoLok-500 is a larger variation of the FalcoLok range. With a standard module size of 4,990mm across the front and a depth of 3,980mm the FalcoLok-500 is a very large equipment/cycle store housed under a single roof span without any internal supports.

As with all products in the range, the FalcoLok-500 can be extended both widthways and in depth, with the option to add doors on both the longer front or shorter side walls.

Installed by many local authorities as well as on private sites, the FalcoLok range is a unique storage solution offering great aesthetic qualities where a utilitarian store is required to not just house equipment but also look good and blend in with the overall design scheme.

All doors are supplied with a Europrofile cylinder lock for added security and can be arranged in either a single or double arrangement.

An eye-catching green sedum roof is available upon request for all of the FalcoLok range of products.



FALCOLOK-500 | with green sedum roof

The FalcoLok series of stores are available in a wide range of cladding options, some of the most popular are detailed below, for a full list please contact our sales team. Alternatively the store can be supplied as a frame only unit allowing the client to use their own series of cladding.



Shiplap Cladding Horizontal and Vertical Hardwood



Welded Mesh Vertical Profiled Aluzinc Verticle Corrugated Steel Powder Coated



FALCOLOK-500 | with polycarbonate roof sheets

FALCOLOK-500	
PART CODE	DESCRIPTION
27.203.000	base section with aluzinc roof sheets
27.213.000	add-on section with aluzinc roof sheets
27.423.000	back or side wall in aluzinc sheets 1mm
27.428.000	back or side wall with hardwood lattice work
27.443.000	end wall in aluzinc sheets 1mm
27.448.000	side wall covering with hardwood lattice work
27.453.000	walkway shut in aluzinc sheets 1mm
27.458.000	walkway shut off with hardwood lattice work
27.463.000	single door in aluzinc sheets 1mm, right
27.468.000	single door with hardwood lattice work, right



Toughened Glass

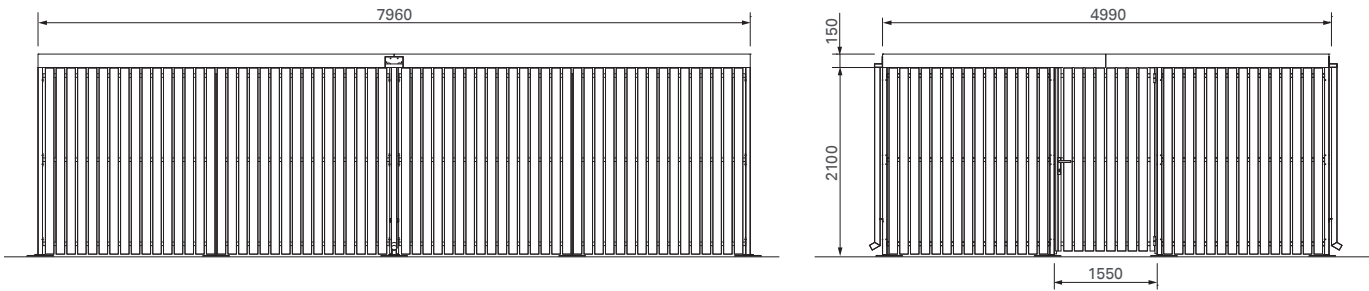

FalcoLok-500, part code 27.203.000 + 27.213.000 + 2x 27.428.000 + 4x 27.448.000 + 1x 27.468.000

SAFETY GLASS AND GRAPHICS

This is the funky cycle hub Falco recently designed, manufactured, supplied and installed at Schiphol North Bus Station, Netherlands. With the use of vinyl graphics and powder coating, the cycle hub can easily match any cycle scheme, brand or theme.



SHELTERED CYCLE SHELTER ENTRANCE

This bespoke FalcoLok shelter is used as a secure lockable cycle parking shelter, with an additional walkway entrance attached to provide additional weather protection.



GREEN TRESPA WALL PANELS

This bespoke green cycle shelter with incorporated window is a perfect example of how a functional cycle store can be combined with an aesthetic appearance.





FALCOLOK-600 CYCLE STORE

The FalcoLok-600 is the largest product from the FalcoLok range. A new variation to the FalcoLok range of secure stores, the FalcoLok-600 is very versatile in width and length and is characterised by its internal spacious design. Ideal for a huge range of applications including a cycle store, sports equipment store, bin store or machinery store, the FalcoLok-600 is both an aesthetic and utilitarian secure store.

There are a huge range of cladding options available for the FalcoLok-600 including: hardwood, polycarbonate, toughened glass, trespa panels, welded mesh and perforated steel, with many other cladding options available upon request. The FalcoLok-600 is also available with a green sedum roof upon request. The FalcoLok-600 has a G section roof frame enabling rain water to be collected and travelled down the drain pipe to be discharged at ground level.

As a versatile unit there are a huge range of modifications that can be made to the store including the relocation of drain pipes, numerous locking mechanisms, cladding in over twelve different options, single or double doors, bespoke dimensions and clear roofing options.

Please contact our technical sales team to discuss your requirements.

The standard unit measures 6335mm long x 3980mm wide x 2250mm high, however there is great scope to extend the store in width, length or height to meet any bespoke requirement. The store has a free head height of 2100mm.

FALCOLOK-600	
PART CODE	DESCRIPTION
27.903.000	base section with aluzinc roof sheets
27.903.000D	base section with aluzinc roof sheets and double doors
27.913.000	add-on section with aluzinc roof sheets
27.948.000	side wall with double door and hardwood lattice work

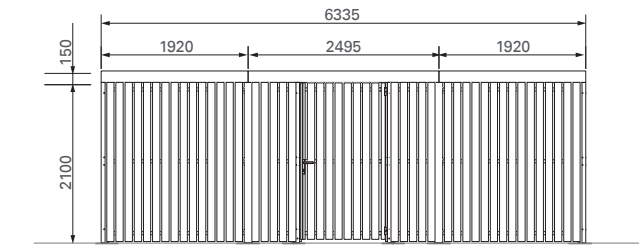

FalcoLok-600, part code 27.903.000

There is a huge range of modifications which can be made to the flagship FalcoLok design. Please contact our technical sales team to discuss how the FalcoLok can be incorporated into your cycle parking cheme on +31 546 55 44 44.

BESPOKE REINFORCED FALCOLOK STORAGE SHELTER

This bespoke FalcoLok shelter was installed for Dutch gas and oil company ‘NAM’ and features reinforced steel cladding panels designed to specifically allow a free flow of oxygen to ventilate the working machinery. The shelter has been modified to provide additional open space below the cladding. The steelwork of the storage shelter was powder coated in RAL 6003 olive green for additional durability.



CONTEMPORARY CYCLE HUB

This is the contemporary cycle hub Falco designed, manufactured, supplied and installed at Dewsbury Railway Station. It provides the TransPennine Express station with a complete cycle hub facility including 60 secure FalcoLevel-Premium+ two-tier cycle parking spaces, a convenient FalcoFix repair and maintenence station and FalcoBloc seating.

The two-tier cycle racks are housed in a bespoke contemporary design of the classic FalcoLok shelter, which feature clean lines through the glass cladding supported by stainless steel glass clamps.



MULTI FUNCTIONEL SHELTER

Falco designed, manufactured, supplied and installed a contemporary storage shelter for a courtyard within the city of Leiden, Netherlands. The storage shelter not only provides secure storage for equipment but has also been modified to incorporate a green sedum roof to help the store blend in with its green surroundings.





FALCOQUARTER SMOKING SHELTER

The FalcoQuarter smoking shelter is one of Falco’s most versatile smoking shelter designs and boasts a combination of great aesthetics with a cost effective price.

The smoking shelter is designed to meet the needs of community projects where budget is the main constrain and provides flexibility in terms of both form and function.



FALCOQUARTER | single sided with FalcoRelax seat <page 36/37>

The smoking shelter is made complete with any of Falco’s seating, litter bin or ashtray designs.

The smoking shelter is available in a wide range of options with bays in 2m, 3m, 4m and 5m variants enabling any size of smoking shelter to be created. The simple design lines mean that the smoking shelter can look inconspicuous if necessary by blending in with most surroundings.

FALCOQUARTER	
PART CODE	DESCRIPTION
78.209.050*	starter section, single sided, length 2,000mm, with polycarbonate roof sheets
78.309.050*	starter section, single sided, length 3,000mm, with polycarbonate roof sheets
78.409.050*	starter section, single sided, length 4,000mm, with polycarbonate roof sheets
78.509.050*	starter section, single sided, length 5,000mm, with polycarbonate roof sheets
78.449.052	end wall in 5mm clear polycarbonate

*All steelwork can be powder coated in any of the 192 standard RAL colours upon request, simply add ‘PC’ to the start of any part code(s) listed to the left.

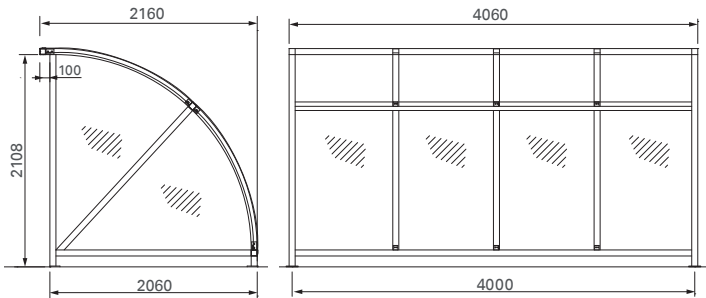

FalcoQuarter, part code 78.409.050 + 78.449.052



FALCOSAIL SMOKING SHELTER

The FalcoSail is a design-led product and from any angle the likeness of a sail ship is unmistakable, making the shelter a very attractive addition for use as a smoking or waiting shelter.

The smoking shelter can be turned into a smoking compound by placing two single units face to face with an optional walkway cover and lockable gates.

FALCOSAIL	
PART CODE	DESCRIPTION
77.309.040*	starter section, single sided, length 3,000mm, with roof and back wall in polycarbonate
77.319.040*	add-on section, single sided, length 3,000mm, with roof an back wall in polycarbonate
77.409.040*	starter section, single sided, length 4,000mm, with roof and back wall in polycarbonate
77.419.040*	add-on section, single sided, length 4,000mm, with roof and back wall in polycarbonate
77.559.050*	starter section, single sided, length 5,000mm, with roof and back wall in polycarbonate
77.569.050*	add-on section, single-sided, length 5,000mm, with roof and back wall in polycarbonate
77.449.052	end wall in 5mm clear polycarbonate



FALCOSAIL | single sided with FalcoBloc bench <page 30/31> and litter bin <pages 64-71>

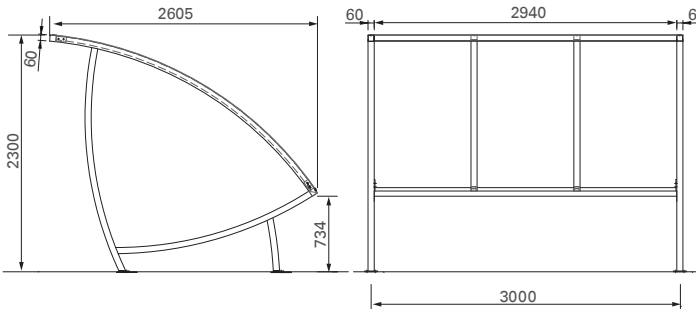

FalcoSail, part code 77.309.050



FALCOLITE

FALCOLITE SMOKING SHELTER

The FalcoLite is our flagship smoking shelter - stylish and functional. With different roof and side wall options, the FalcoLite is easily capable of combining with our huge ranges of seating, litter bins and ashtray designs.

All steelwork on the FalcoLite smoking shelter is hot dip galvanised and can be powder coated in a RAL colour upon request.



FALCOLITE | single sided with FalcoSwing bench <page 44/45> and Tempo ashtray <page 72>

FALCOLITE SINGLE SIDED	
PART CODE	DESCRIPTION
76.309.050	starter section, roof and back wall polycarbonate
PC76.309.050	starter section, roof and back wall polycarbonate, steelwork powder coated in RAL ____
76.319.050	add-on section, roof and back wall polycarbonate
PC76.319.050	add-on section, roof and back wall polycarbonate, steelwork powder coated in RAL ____
76.349.052	end wall closed in clear polycarbonate

Available in three distinct variants; single sided, double-sided or as a compound.

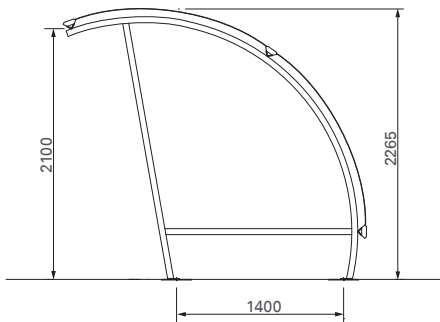

FalcoLite, part code 76.309.050 + 76.319.050



FALCOLITE DOUBLE-SIDED SHELTER

The double sided version of the shelter brings two FalcoLite shelters back to back in an attractive 'Gull wing' effect.

FALCOLITE DOUBLE SIDED	
PART CODE	DESCRIPTION
76.409.050	starter section, roof and back wall polycarbonate
PC76.409.050	starter section, roof and back wall polycarbonate, steelwork powder coated in RAL ____
76.419.050	add-on section, roof and back wall polycarbonate
PC76.419.050	add-on section, roof and back wall polycarbonate, steelwork powder coated in RAL ____
76.449.052	end wall in 1 part, polycarbonate

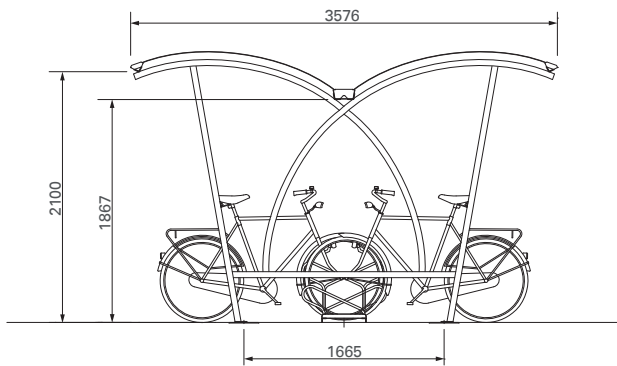

FalcoLite, part code 76.409.050



Compounds have the advantage of providing wide coverage whilst retaining maximum visibility.

FALCOLITE COMBI	
PART CODE	DESCRIPTION
76.369.050	walkway starter section, polycarbonate covering
76.379.050	walkway add-on section, polycarbonate covering
76.389.052	walkway closure of polycarbonate covering, delivery together with the shelter
76.390.052	walkway covering with single revolving door of polycarbonate, delivery together with the shelter

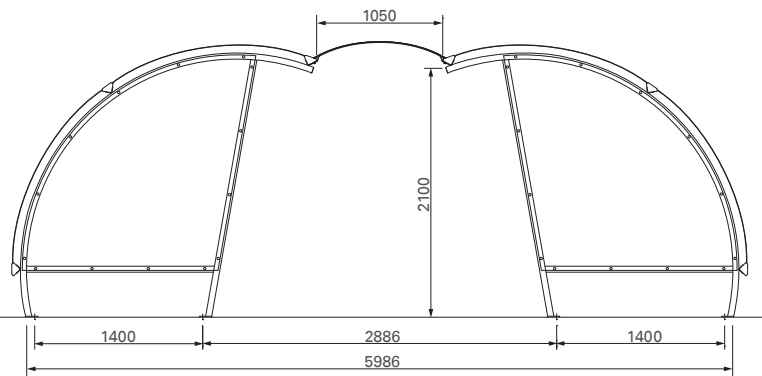

FalcoLite 2x part code 76.309.050 + 1x part code 76.369.050



FALCOBREEZE | with FalcoNorma seat <page 24>

FALCOBREEZE SMOKING SHELTER

The FalcoBreeze smoking canopy is a great application for areas of a higher density. Increasingly on busy streets and walkways, sign posts and street furniture are reducing the amount of available spaces for pedestrians to walk, so the FalcoBreeze canopy creates a great overhead canopy area whilst occupying a minimum of floor space.

*All steelwork on the FalcoBreeze canopy is hot dip galvanised to BS EN ISO 1461 and can be polyester powder coated in any of the 192 standard RAL colours to match a corporate colour.

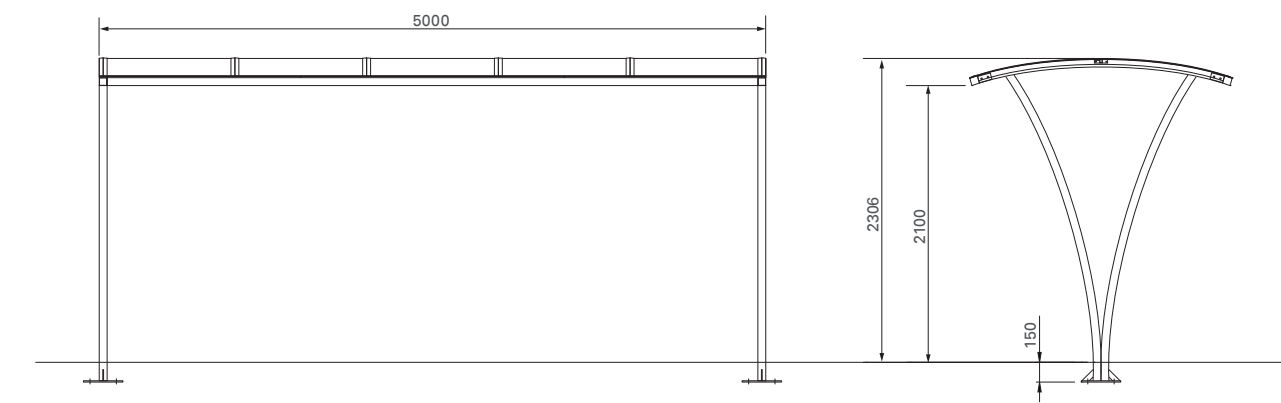

FalcoBreeze starter section, part code 72.509.050

The FalcoBreeze is available in 2m, 3m, 4m and 5m variants.

FALCOBREEZE	
PART CODE	DESCRIPTION
72.209.050*	starter section, length 2,000mm
72.219.050*	add-on section, length 2,000mm
72.309.050*	starter section, length 3,000mm
72.319.050*	add-on section, length 3,000mm
72.409.050*	starter section, length 4,000mm
72.419.050*	add-on section, length 4,000mm
72.509.050*	starter section, length 5,000mm
72.519.050*	add-on section, length 5,000mm



FALCOBREEZE CYCLE SHELTER <page 162/163>



FALCOSPAN SMOKING SHELTER

The FalcoSpan series of canopies offers great flexibility when providing an uncomplicated smoking shelter. An exceptionally attractive and open shelter, very simple construction and very aesthetical. The cantilevered design is topped with a robust roof section which contains integral gutters enabling waste water to be discharged at ground level via the supporting uprights. The standard roof sheets are in aluzinc corrugated metal, but other options are available if you require something to let the light in.

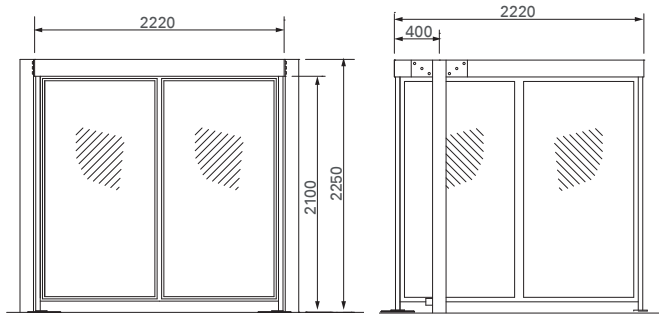

FalcoSpan + Glass Walls

FALCOSPAN	
PART CODE	DESCRIPTION
21.144.000L	starter/end support, length 2,250mm with 500mm anchor piece for below ground fix, for roof section upto 2,220mm deep
21.027.000	roof section 2220x4340x150mm, with aluzinc profiled sheets
21.133.170	prefab back wall 2220x2000mm with safety glass, fixed in clamping strips, including 2 supports with anchor parts
21.230.000	end support on base plate for installation of wall element
21.231.000	corner support on base plate for installation of wall element
21.231.170	prefab back wall 4340x2000mm with safety glass, fixed in clamping strips, including 2 supports with anchor part



NAVAHO | with FalcoSwing benches <page 45/46> and litter bin <pages 64-71>

NAVAHO SMOKING SHELTER

The Navaho is a really versatile smoking shelter. An ideal structure for smoking, recreation use or as a parent waiting shelter. Available with coloured roof panels, you can create a matrix pattern of highly distinctive colours.

There are several options to close one or more sides of the Navaho shelter. Generally the transparent option is chosen with safety glass panels. Other options are aluzinc profiled steel sheets or wooden slats.

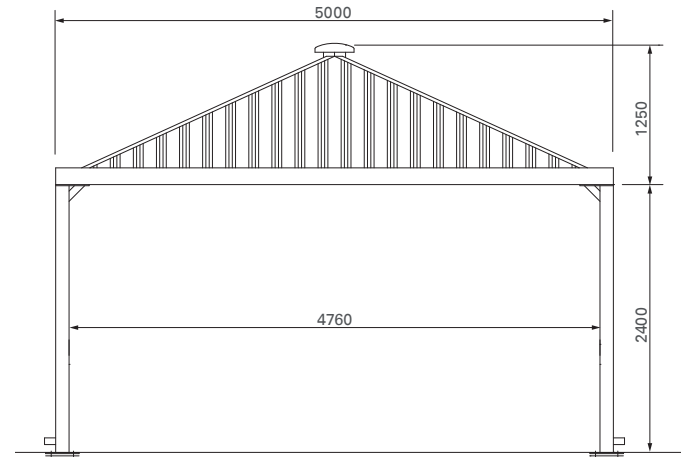

Navaho, part code 65.500.000

NAVAHO	
PART CODE	DESCRIPTION
65.500.000	starter section, dim. 5,000x5,000mm
PC65.500.000	starter section, dim. 5,000x5,000mm, steel
	construction powder coated in RAL ____
PCA65.500.000	starter section, dim. 5,000x5,000mm, steel
	construction and roof powder coated in RAL ____
65.510.000	add-on section, dim. 5,000x5,000mm
PC65.510.000	add-on section, dim. 5,000x5,000mm, steel
	construction powder coated in RAL ____
PCA65.510.000	add-on section, dim. 5,000x5,000mm, steel
	construction and roof powder coated in RAL ____
65.520.000	side wall in aluzinc profiled steel sheets
PC65.520.000	side wall in aluzinc profiled steel sheets,
	steel construction powder coated in RAL ____
PCA65.520.000	side wall in aluzinc profiled steel sheets,
	steel sheets powder coated in RAL ____
65.520.170	side wall in safety glass
PC65.520.170	side wall in safety glass,
	columns powder coated in RAL ____

It is also possible to transform the Navaho design into a storage shelter with single or double doors.



NAVAHO | multicoloured, powder coated roof



FALCOTRUSTIN SMOKING CANOPY

The FalcoTrustin is a new product in our smoking canopy portfolio that offers great flexibility when providing an uncomplicated smoking shelter or canopy. The canopy is an exceptionally attractive and open shelter with a very simple construction and great aesthetics. A bonus to the FalcoTrustin design is the flexibility to optimise the smoking shelter to meet any dimension, with standard square roof sections of 1,000mm x 1,000mm and a standard bay length of 4,000mm, the FalcoTrustin can be extended in length up to any dimension - to match any bespoke requirement.

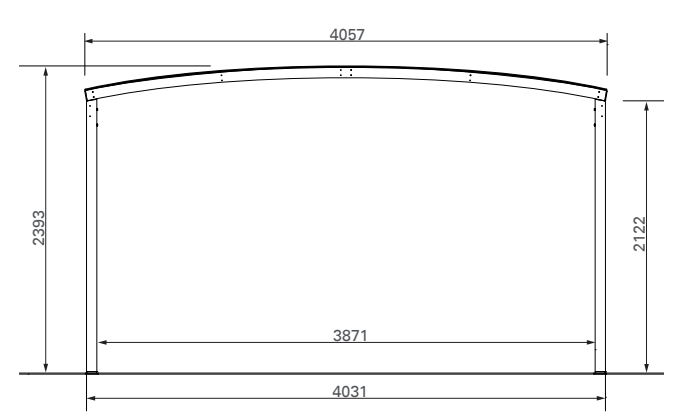

FalcoTrustin, part code 28.409.050

FALCOTRUSTIN	
PART CODE	DESCRIPTION
28.309.050	starter section with polycarbonate roof sheets,
	length 3,000mm, depth 4,000mm,
	height 2,100-2,320mm
28.319.050	add-on section with polycarbonate roof sheets,
	length 3,000mm, depth 4,000mm,
	height 2,100-2,320mm
28.409.050	starter section, with polycarbonate roof sheets,
	length 4,000mm, depth 4,000mm,
	height 2,100-2,400mm
28.419.050	add-on section, with polycarbonate roof sheets,
	length 4,000mm, depth 4,000mm,
	height 2,100-2,400mm
28.509.050	starter section, with polycarbonate roof sheets,
	length 5,000mm, depth 4,000mm,
	height 2,100-2,500mm
28.519.050	add-on section, with polycarbonate roof sheets,
	length 5,000mm, depth 4,000mm,
	height 2,100-2,500mm



FALCOTEL-L SMOKING SHELTER

The FalcoTel-L is the wall mounted version of the FalcoTel range. A highly economical canopy requiring a sturdy wall to bolt to (150mm minimum recommended). The FalcoTel-L is ideal as a smoking shelter, waiting shelter or cycle shelter. The canopy is 4,000mm long x 2,440mm wide, the roof sheets are manufactured from corrugated aluzinc sheets.



FALCOTEL-L | with FalcoStretto seat <page 27>

FALCOTEL-L	
PART CODE	DESCRIPTION
23.300.000	starter section, length 4,000mm
23.310.000	add-on section, length 4,000mm
88.823.000	steel drainpipe for FalcoTel-L

It can be mounted at any height from the floor, though a standard distance of 2,095mm is recommended.

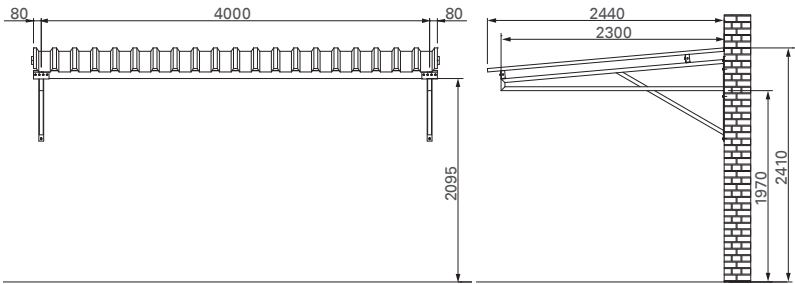

FalcoTel-L, part code 23.300.000

SHELTERS FOR DISABLED FOOTBALL FANS

Falco recently designed, manufactured, supplied and installed disabled spectator canopies for Willem II football club in Tilburg, Netherlands. The club was looking for a solution to provide wide sheltered coverage for its disabled spectators and approached Falco to discuss a number of possible solutions.

Falco’s technical design team modified the FalcoTel canopy design and adjusted the height of the roof to ensure the view from the spectators behind wasn’t compromised. The roof panels were adapted to incorporate transparent polycarbonate sheets to receive a maximum low of light.

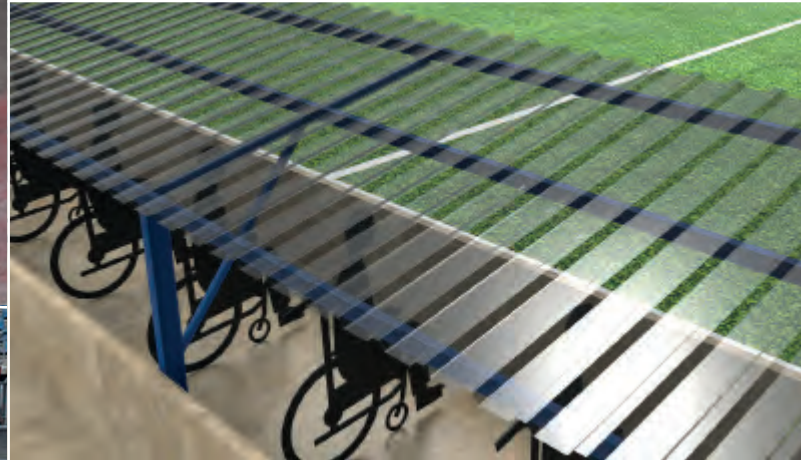



FALCOLOK-250 SECURE STORE

The FalcoLok-250 is the smallest product from the FalcoLok range.

There are a huge range of flexible options for the FalcoLok-250 including cladding in over 12 different materials, the relocation of single or double doors, the relocation of the drain pipe and the option of extending in width, length or height.

The store has an overall height of 2,250mm and a free head height of 2,100mm.

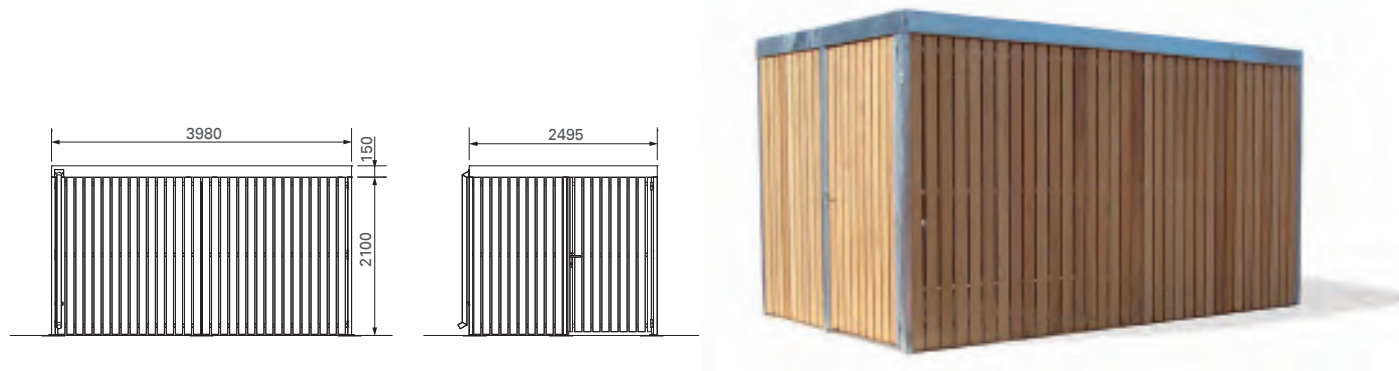

FALCOLOK-250 | with single door



FALCOLOK-300 | steelwork powder coated

FALCOLOK-300 SECURE STORE

A slightly larger variation from the FalcoLok-250, the FalcoLok-300 measures 3,120mm at the front x 3,980mm deep.

There are a huge range of additional options for the FalcoLok range including specific dimensions in length, width and height as well as over 12 cladding options, numerous locking mechanisms, relocation of single or double doors, clear roofing options and numerous drainage positions.

The unit can also be reconfigured (as the image above) to 3,980mm at the front x 3,120mm deep.



FALCOLOK-300 | with double door

FALCOLOK-300	
PART CODE	DESCRIPTION
27.553.000D	base section, dim. 3,120x3,980mm, height 2100/2250mm,
	with double door in the 312cm side
OND27.000.351	drainpipe for 2 roof sections
27.428.000	steel side frames including standard hardwood cladding
27.448.000	end wall covering in standard hardwood
27.458.000	walkway shut including standard hardwood cladding
27.558.000	cladding in standard hardwood for end wall and double doors in standard hardwood

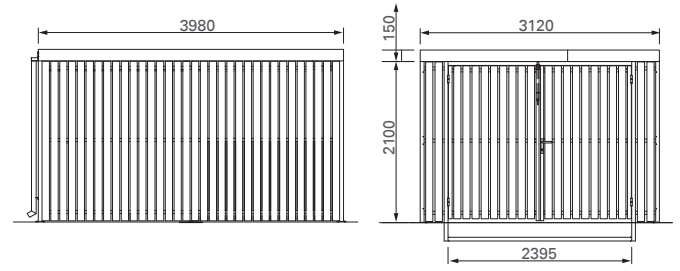

FalcoLok-300 with double door



FALCOLOK-500 SECURE STORE

With a standard module size of 4,990mm across the front and a depth of 3,980mm the FalcoLok 500 secure store is a very large storage shelter/refuse store housed under a single roof

FALCOLOK-500	
PART CODE	DESCRIPTION
27.203.000	base section with aluzinc roof sheets
27.213.000	add-on section with aluzinc roof sheets
27.428.000	back or side wall with hardwood lattice work
27.448.000	side wall covering with hardwood lattice work
27.458.000	walkway shut off with hardwood lattice work
27.468.000	single door with hardwood lattice work, right
OND27.468.000	steel drain for two FalcoLok-500 roofs

span without internal supports. As with the FalcoLok-250 and FalcoLok-300, the FalcoLok-500 is very versatile in design with a huge range of customisable options.

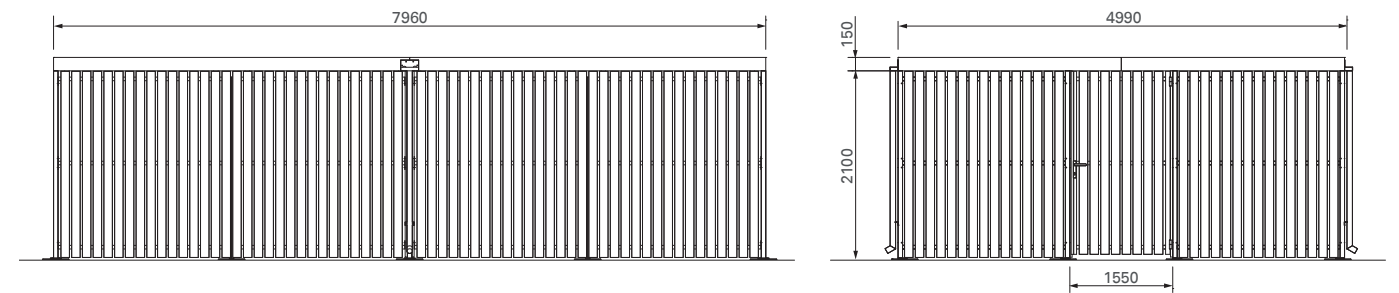

FalcoLok-500, part code 27.203.000 + 27.213.000 + 2x 27.428.000 + 4x 27.448.000 + 1x 27.468.000



FALCOLOK-600 SECURE STORE

A new variation to the FalcoLok range of secure stores, the FalcoLok-600 is very versatile in width and length and is characterised by its internal spacious design. Ideal for a huge range of applications including a cycle store, sports equipment store, bin store or machinery store, the FalcoLok-600 is both an aesthetic and utilitarian secure store. There are a huge range of cladding options available for the FalcoLok-600 including: hardwood, polycarbonate, toughened glass, trespas panels, welded mesh and perforated steel, with many other cladding options available upon request. The FalcoLok-600 is also available with a green sedum roof upon request. The FalcoLok-600 has a G section roof frame enabling rain water to be collected and travelled down the drain pipe to be discharged at ground level.

As a versatile unit there are a huge range of modifications that can be made to the store including the relocation of drain pipes, numerous locking mechanisms, cladding in over twelve different options, single or double doors, bespoke dimensions and clear roofing options.

FALCOLOK-600	
PART CODE	DESCRIPTION
27.903.000	base section with aluzinc roof sheets
27.903.000D	base section with aluzinc roof sheets and double door
27.913.000	add-on section with aluzinc roof sheets
27.948.000	side wall with double door and hardwood lattice work

The standard unit measures 6335mm long x 3980mm wide x 2250mm high, however there is great scope to extend the store in width, length or height to meet any bespoke requirement. The store has a free head height of 2100mm.

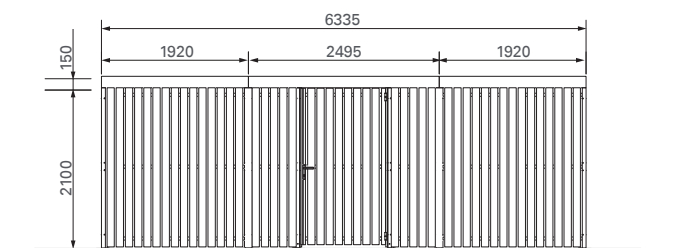

FalcoLok-600, part code 27.903.000



FALCOTEL-K SECURE STORE

The FalcoTel-K shelter enables the FalcoTel range to become a secure store. At 2,900mm deep, the FalcoTel-K is slightly deeper than the standard range of storage shelters and is ideal for a huge range of equipment.

The store can be clad in a variety of finishes including hardwood slats, corrugated aluzinc sheets or wire mesh.

There are a number of permutations for positioning of the door (ask our sales department). Single or double doors are able to be positioned in either the front or side walls.

The storage shelter also comes complete with a Europrofile cylinder lock.

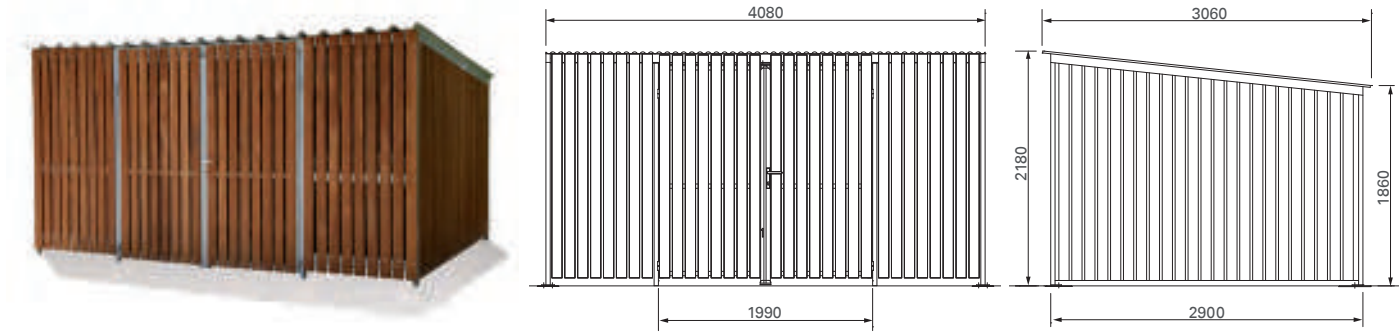

FALCOTEL-K | with double doors



FALCOGRAND STORAGE SHELTER

The largest of the Falco range of shelters, the FalcoGrand is an ideal product to shelter cars, vans or even our two-tier cycle parking system.

The front opening is 4,800mm to enable maximum access and if required front walls with single or double doors are also available. Rain water is directed to integral gutters and downspouts.

The roof has standard aluzinc sheets. All steel work is hot dip galvanized to BS EN ISO1461 and can be powder coated if required.

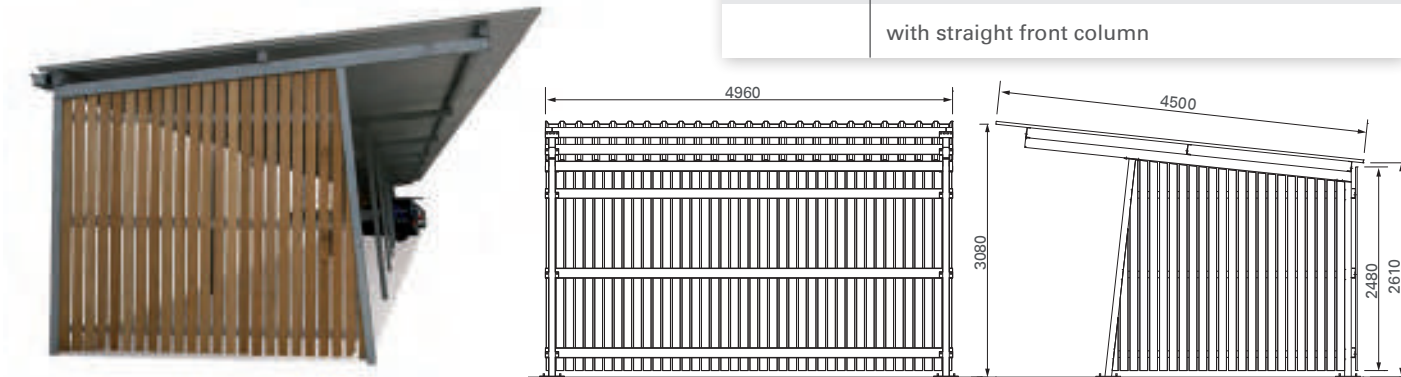

FALCOGRAND | single sided with add-on sections



FALCOROLLER BUGGY/WHEELCHAIR SHELTER

The FalcoRoller is a purpose designed buggy, pram and wheelchair storage shelter. An ideal product for hospitals, nurseries, primary schools and various attractions, the FalcoRoller is 3,750mm wide and can accomodate up to five push chairs in a single bay unit.

The shelter is hot-dip galvanised as standard and can be powder coated in any of the 192 RAL colours upon request.

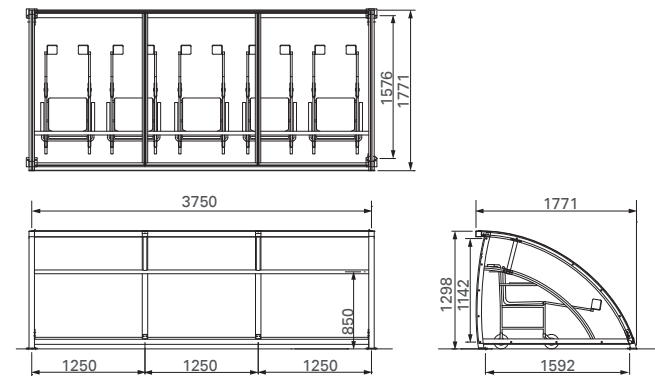

FALCOROLLER

FALCOROLLER	
PART CODE	DESCRIPTION
77.509.050	single sided starter section, roof and back wall of clear polycarbonate
77.549.052	prefab end wall covering of clear polycarbonate
77.520.000	fixing beam for FalcoRoller, length 3,708mm
77.549.052	prefab end wall covering of polycarbonate

Additionally the shelter has an optional locking rail for the user to secure the pushchair to if it is being placed in a non-secure environment. Plastic strips can also be added upon request for additional weather protection.



FALCOBOX STORAGE SHELTER

Creativity, innovation, practicality and durability, the FalcoBox incorporates all four features to create the first of its kind – an extraordinary outdoor storage facility!

The FalcoBox is ideal for storing a wide range of items including: push chairs, play equipment, sports equipment, tools and machinery. Each roof is equipped with two gas struts to facilitate the process of lifting, each roof will remain open until pushed back down again.

The FalcoBox is available in one, two or three bays.

The **single bay** is 2435mm long, 1620mm wide, 1062mm high (closed) and 2126mm high (open).

The **double bay** is 4870mm long, 1620mm wide, 1062mm high (closed) and 2125mm high (open).

The **triple bay** is 7305mm long, 1620mm wide, 1062mm high (closed) and 2125mm high (open).

FALCOBOX	
PART CODE	DESCRIPTION
27.906.001	single bay, 1 set of double doors, 2435mm long
27.906.002	double bay, 2 sets of double doors, 4870mm long
27.906.003	triple bay, 3 sets of double doors, 7305mm long

The storage unit is manufactured from hot dip galvanised steel with hardwood cladding.

Optionally available in Trespa upon request.

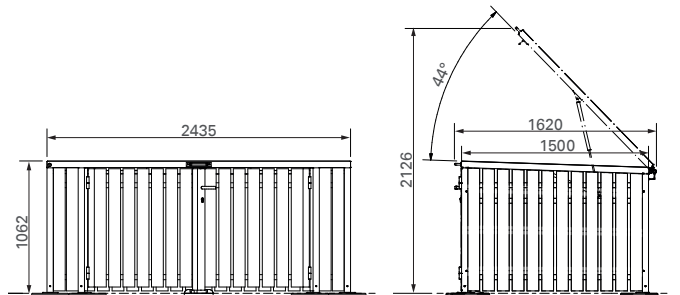

FalcoBox, part code 27.906.001



FALCOTRUSTIN WALKWAY/CARPORT

The FalcoTrustin is an ideal product to create a walkway structure for as long as required. Also ideal as a carport, smoking shelter, waiting shelter and cycle shelter.

The FalcoTrustin has a very spacious and light design thanks to the increased use of polycarbonate roof sheets.

FALCOTRUSTIN	
PART CODE	DESCRIPTION
28.309.050	starter section, length 3,000mm, depth 4,000mm, height 2,100-2,320mm
28.319.050	add-on section, length 3,000mm, depth 4,000mm, height 2,100-2,320mm
28.409.050	starter section, length 4,000mm, depth 4,000mm, height 2,100-2,400mm
28.419.050	add-on section, length 4,000mm, depth 4,000mm, height 2,100-2,400mm
28.509.050	starter section, length 5,000mm, depth 4,000mm, height 2,100-2,500mm
28.519.050	add-on section, length 5,000mm, depth 4,000mm, height 2,100-2,500mm



FALCOTRUSTIN CARPORT

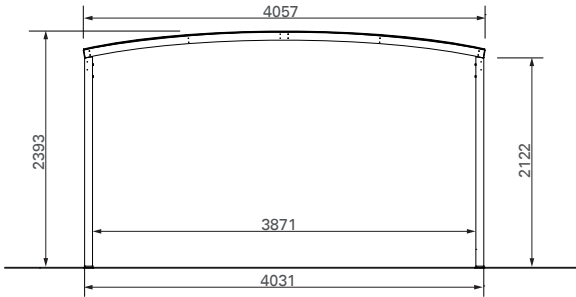

FalcoTrustin, part code 28.409.050



FALCOPLANA CARPORT

The FalcoPlana is a heavy-duty multi purpose canopy with a simple, sleek design, providing a versatile structure for; walkways, carports, cycle parking and entrance canopies.

The modular canopy features unobtrusive integral gutters enabling waste water to be discharged at ground level via the supporting uprights.

FALCOPLANA	
PART CODE	DESCRIPTION
29.200.002	starter section, dim. 5,000x5,000mm
29.200.102	add-on section, dim. 5,000x5,000mm

The canopy can be extended with the use of add-on sections in either width or length allowing any shelter size to be created. The roof sheets are available in aluzinc steel profile sheets or clear polycarbonate to give the shelter a lighter look.

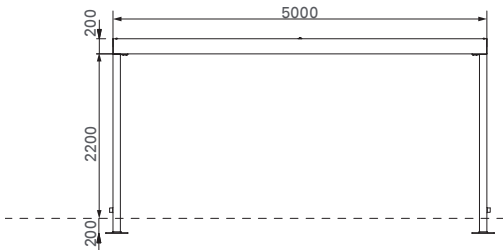

FALCOPLANA | 29.200.002



FALCOSPAN CANOPY AND WALKWAY

The FalcoSpan is a very popular canopy and walkway design having been used for schools, hospitals and shopping centres. Falco can provide full project management for any of our walkway designs, from design through to manufacture, groundwork, supply and installation, Falco offer a complete project management service.

In two standard depths - 1,690mm and 2,220mm, the FalcoSpan is available in seven different widths providing huge flexibility: 2,220mm, 2,750mm, 3,280mm, 3,810mm, 4,340mm, 4,870mm and 5,400mm

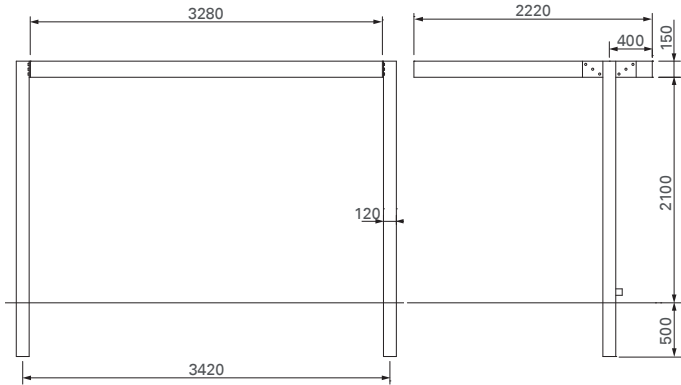

FalcoSpan, 21.025.000 + 21.144.000L + 21.144.000R

The standard roof sheets are aluzinc corrugated steel, but other options are available in safety glass or polycarbonate.

FALCOSPAN	
PART CODE	DESCRIPTION
21.023.000	roof of aluzinc sheets, 2,220x2,220mm
21.024.000	roof of aluzinc sheets, 2,750x2,220mm
21.025.000	roof of aluzinc sheets, 3,280x2,220mm
21.026.000	roof of aluzinc sheets, 3,810x2,220mm
21.027.000	roof of aluzinc sheets, 4,340x2,220mm
21.028.000	roof of aluzinc sheets, 4,870x2,220mm
21.029.000	roof of aluzinc sheets, 5,400x2,220mm
21.144.000L	left starter/end supporting column 120x120mm, to grout in
21.144.000R	right starter/end supporting column 120x120mm, to grout in
21.144.000T	intermediar supporting column 120x120mm, to grout in
21.152.000	prefab roof joining frame when using 21.144.000T



FALCOCREA SECURE STORE

The FalcoCrea was developed from a growing demand for secure cycle storage for private homes and community neighbourhoods.

Based on the flagship FalcoLok design, the FalcoCrea retains the same design characteristics but in a much sleeker and compact design.

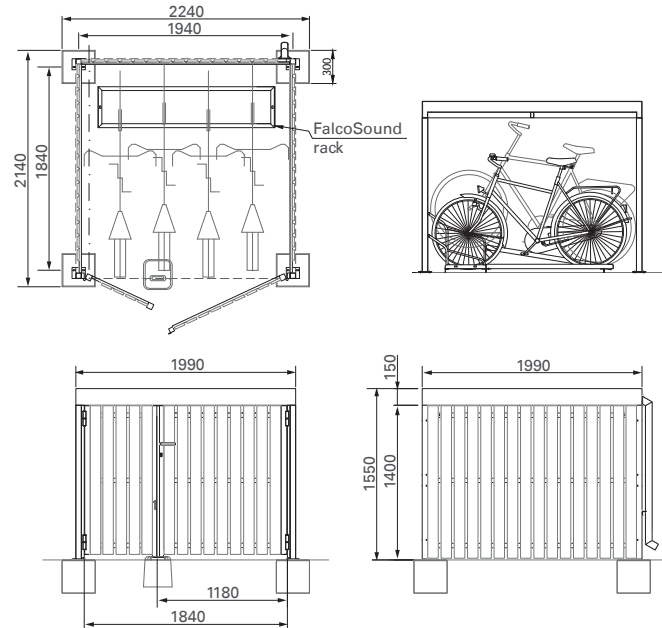

FalcoCrea

There is a huge number of modifications which can be made to the FalcoCrea store including a wide range of different cladding options, dimensions, green sedum roofs, locking systems and shelter access.

The FalcoCrea can securely accommodate up to four bikes.

